

Lotus Europa TC/TCS Parts Manual - Section MA - Electrical - Major Components - Page 2

Item	Lotus #	S1	S1A/B	S2	S2 Fed	TC	TC Fed	TCS	TCS F	LHD	RHD	Description	Change Point Notes Bulletin Reference
	A074M0188W					1	1	1		+	+	Loom - Main	
	B074M0188W								1			Loom - Main	
	A074M0189W					1	1	1		+	+	Loom - Facia/Window Lift	
	B074M0224Z								1			Loom - Facia/Window Lift	
	A074M0190W					1	1	1		+	+	Loom - Panel Lamp	
	B074M0190W								1			Loom - Panel Lamp	
	A054M0792W						1					Loom - Hazard Warning	
	A074M0203W					1		1			+	Loom - Hazard Warning	
	X054M0785Z					1	1	1			+	Loom - Brake Fail	
	A074M0209Z						1		1			Seat Belt Warning	
	A074M0222Z						1		1			Lead - Extension - Seat Belt Warning	
1	A074E6000Z					1	1	1	1			Alternator	
2	A074E0133Z					1	1	1	1			Arm - Adjusting	
3	9					1	1	1	1			Bolt	
3	116					1	1	1	1			Washer	
3	211					1	1	1	1			Nut	
4	X036M6002Z					1	1	1	1			Battery	
5	A074M0919Z					1	1	1	1			Cable - Battery to Earth	
6	X046M0046Z					1	1	1	1			Cable - Battery to Starter	
6	XUCB0416Z					2	2	2	2			Bolt - Cables to Battery Terminals	
6	110					2	2	2	2			Washer - Cables to Battery Terminals	
6	206					2	2	2	2			Nut - Cables to Battery Terminals	
7	A074E6010Z					1	1	1	1			Motor - Starter	
8	X036M6298Z					1	1	1	1			Coil - Ignition	
9	E026M0009W					1		1		+	+	Distributor	
9	G026M0009W						1		1			Distributor comprising:	
9	X028M0073Z					1	1	1	1			Distributor Cap	
9	X036M6057Z					1	1	1	1			Bush and Spring - Distributor	
9	X028M0070Z					1	1	1	1			Rotor Arm - Distributor	
9	A036M6362Z					1	1	1	1			Contact Breaker Set (Quick Fit) - Distributor (points)	
9	X036M6060Z					1	1	1	1			Condensor - Distributor	
9	A026M6091Z					1	1	1	1			Screw - Distributor to Block	
10	A036E0816W					1	1	1	1			Harness Spark Plug Cable Set - Ignition	

MA

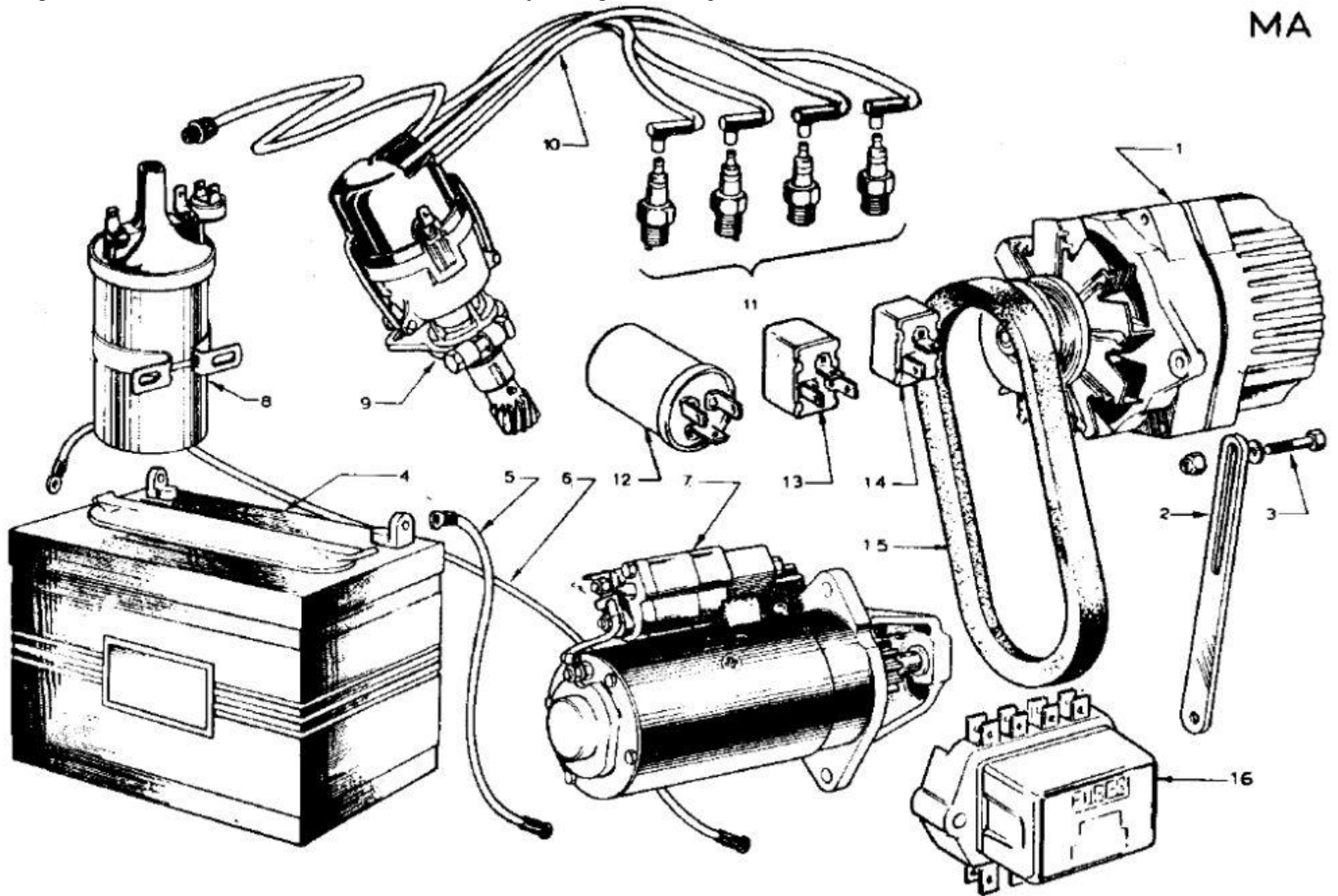

Lotus Europa TC/TCS Parts Manual - Section MA - Electrical - Major Components - Page 4

Item	Lotus #	S1	S1A/B	S2	S2 Fed	TC	TC Fed	TCS	TCS F	LHD	RHD	Description	Change Point Notes Bulletin Reference
10	A074E0740Z					1	1	1	1			Harness Spark Plug Cable Set - Ignition (Replaced by A036E0816W)	
11	A036M6412Z					4	4	4	4			Spark Plug	
12	X036M6270Z					1		1			+	Unit - Hazard Flasher	
13	A036M6334Z						1					Unit - Hazard Flasher	
13	A007M4124Z								1			Unit - Hazard Flasher	
14	X036M6300Z					1	1	1	1			Unit - Indicator Flasher	
14	X036M6301Z					1	1	1	1			Clip - Securing - Unit - Indicator Flasher	
15	A074E6008Z					1	1	1	1			Drive Belt - Alternator	
16	A074M6001W					1	1	1	1			Fuse Box	
16	X026M0039Z					1	1	1	1			Lead - Earth - Engine to Chassis	
16	X036B1079Z					1	1	1	1			Horn - High Note	
16	X036B1080Z					1	1	1	1			Horn - Low Note	
16	X026B0403Z					2	2	2	2			Spacer - horn to Body	
16	X050M6056Z					1	1	1	1			Set - Air Horn (Optional)	
16	X0501526Z					1	1	1	1			Bracket - Air Horn Mounting	