

Lotus Europa TC/TCS Parts Manual - Section FH - Transmission - Gearset (365) - Page 2

Item	Lotus #	S1	S1A/B	S2	S2 Fed	TC	TC Fed	TCS	TCS F	LHD	RHD	Description	Change Point Notes Bulletin Reference
1	A074F6052Z							1	1	+	+	Clutch Shaft	
2	A074F6091Z							1	1	+	+	Primary Shaft	
3	A074F6090Z							1	1	+	+	Bearing	
4	A074F6088Z							1	1	+	+	Circlip - Inner	
5	A074F6089Z							1	1	+	+	Circlip - Outer	
6	A046F6033Z							1	1	+	+	Roll Pin	
7	A074F6122Z							1	1	+	+	Bearing	
8	A074F6100Z											Shim - 3.00 mm. (As Required)	
8	A074F6101Z											Shim - 3.25 mm. (As Required)	
8	A074F6102Z											Shim - 3.50 mm. (As Required)	
8	A074F6103Z											Shim - 3.75 mm. (As Required)	
8	A074F6104Z											Shim - 4.00 mm. (As Required)	
8	A074F6105Z											Shim - 4.25 mm. (As Required)	
8	A074F6106Z											Shim - 4.50 mm. (As Required)	
8	A074F6107Z											Shim - 4.75 mm. (As Required)	
8	A074F6108Z											Shim - 5.00 mm. (As Required)	
8	A074F6109Z											Shim - 5.25 mm. (As Required)	
8	A074F6110Z											Shim - 5.50 mm. (As Required)	
9	A074F6121Z							1	1	+	+	Spacer	
10	A074F6120Z							1	1	+	+	Sleeve	
11	A074F6119Z							1	1	+	+	Bearing - Needle Roller	
12	A074F6223Z							1	1	+	+	Gear - 5th Primary	
13	A074F6117Z							1	1	+	+	Synchroniser Hub 5th	
14	A074F6095Z							1	1	+	+	Synchroniser Ring	
15	A074F6114Z							6	6	+	+	Key	Type 365-04
15	A074F6114Z							3	3	+	+	Key	Type 365-07
16	A074F6099Z							3	3	+	+	Synchro Spring	
17	A074F6115Z							1	1	+	+	Circlip Inner	
18	A074F6112Z							2	2	+	+	Washer	
19	A074F6116Z							1	1	+	+	Nut	
20	A074F6123Z							1	1	+	+	Shaft - Reverse Gear	
21	A074F6124Z							1	1	+	+	Reverse Gear	
22	X046F6026Z							1	1	+	+	Thrust Washer	

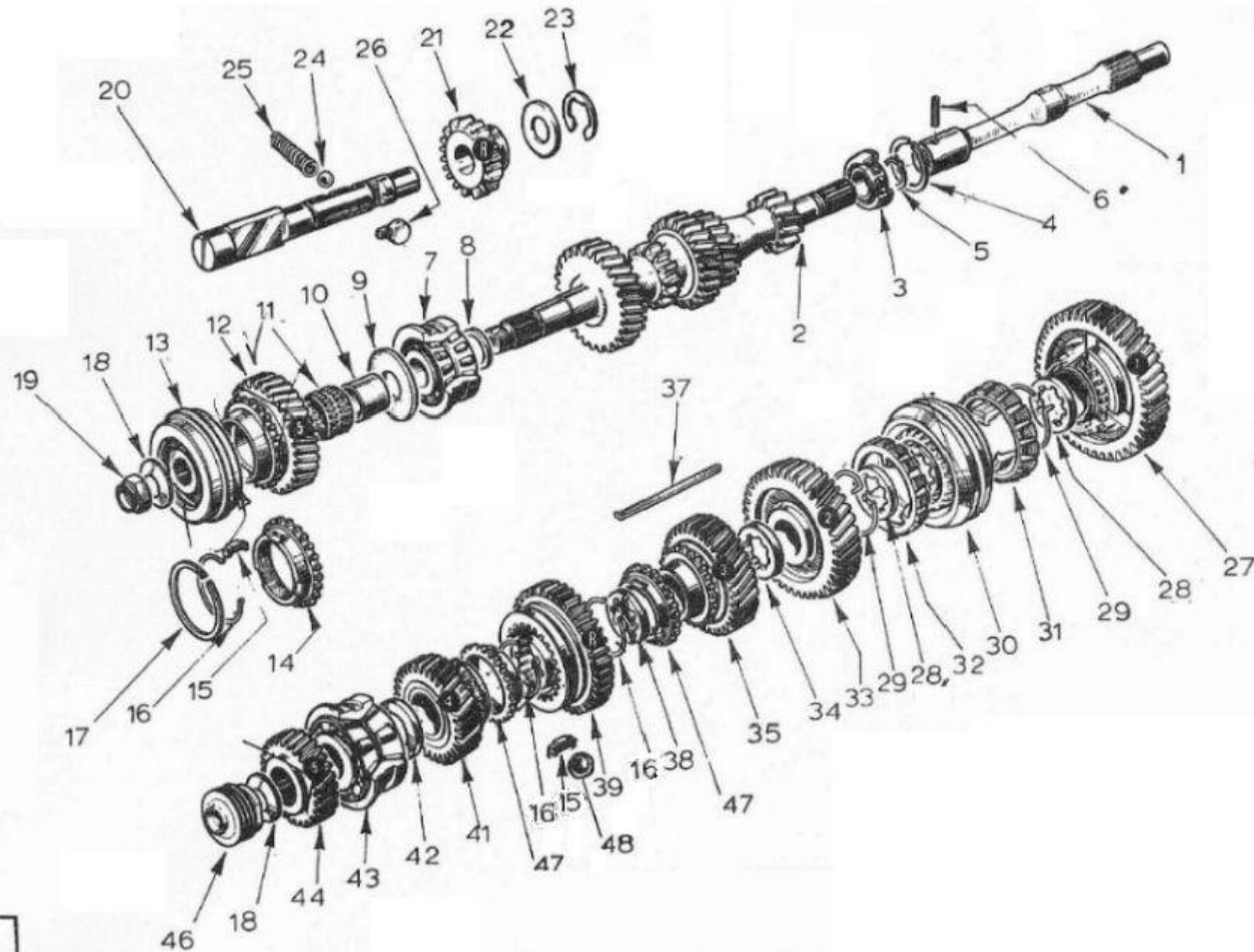

Lotus Europa TC/TCS Parts Manual - Section FH - Transmission - Gearset (365) - Page 4

Item	Lotus #	S1	S1A/B	S2	S2 Fed	TC	TC Fed	TCS	TCS F	LHD	RHD	Description	Change Point Notes Bulletin Reference
23	X046F6025Z							1	1	+	+	Circlip	
24	A046F6030Z							1	1	+	+	Locking Ball	
25	A046F6029Z							1	1	+	+	Spring	
26	A046F6032Z							1	1	+	+	Guide	
27	X046F6053Z							1	1	+	+	Gear - 1st	Type 365-04
27	A074F6161Z							1	1	+	+	Gear - 1st	Type 365-07
28	X046F6038Z							2	2	+	+	Stop Washer	
29	X046F6052Z							2	2	+	+	Synchro Spring	
30	A074F6092Z							1	1	+	+	Synchro Hub 1st/2nd (Medium Blue)	Type 365-04
30	A074F6163Z							1	1	+	+	Synchro Hub 1st/2nd (Yellow/Red)	Type 365-07
30	A074F6093Z							1	1	+	+	Synchro Hub 1st/2nd (Yellow)	Type 365-04
30	A074F6164Z							1	1	+	+	Synchro Hub 1st/2nd (White)	Type 365-07
31	X046F6054Z							1	1	+	+	Synchro Ring 1st	Type 365-04
31	A074F6162Z							1	1	+	+	Synchro Ring 1st	Type 365-07
32	X046F6060Z							1	1	+	+	Synchro Ring 2nd	Type 365-04
32	A074F6165Z							1	1	+	+	Synchro Ring 2nd	Type 365-07
33	A074F6094Z							1	1	+	+	Gear 2nd	Type 365-04
33	A074F6166Z							1	1	+	+	Gear 2nd	Type 365-07
34	X046F6062Z							1	1	+	+	Stop Washer	
35	A074F6125Z							1	1	+	+	Gear 3rd	Type 365-04
35	A074F6167Z							1	1	+	+	Gear 3rd	Type 365-07
37	X046F6063Z							1	1	+	+	Key	
38	A074F6076Z							1	1	+	+	Stop Washer	Type 365-04
38	A074F6169Z							1	1	+	+	Stop Washer	Type 365-07
39	A074F6097Z							1	1	+	+	Synchro Hub 3rd/4th (Medium Blue)	Type 365-04
39	A074F6170Z							1	1	+	+	Synchro Hub 3rd/4th (Blue/White)	Type 365-07
39	A074F6098Z							1	1	+	+	Synchro Hub 3rd/4th (Yellow)	Type 365-04
39	A074F6171Z							1	1	+	+	Synchro Hub 3rd/4th (Red)	Type 365-07
41	A074F6156Z							1	1	+	+	Gear 4th	Type 365-04
41	A074F6173Z							1	1	+	+	Gear 4th	Type 365-07
42	X046F6064Z									+	+	Shim - 3.50 mm. (As Required)	Type 365-04 Only
42	X046F6065Z									+	+	Shim - 3.55 mm. (As Required)	Type 365-04 Only
42	X046F6066Z									+	+	Shim - 3.60 mm. (As Required)	Type 365-04 Only

FH

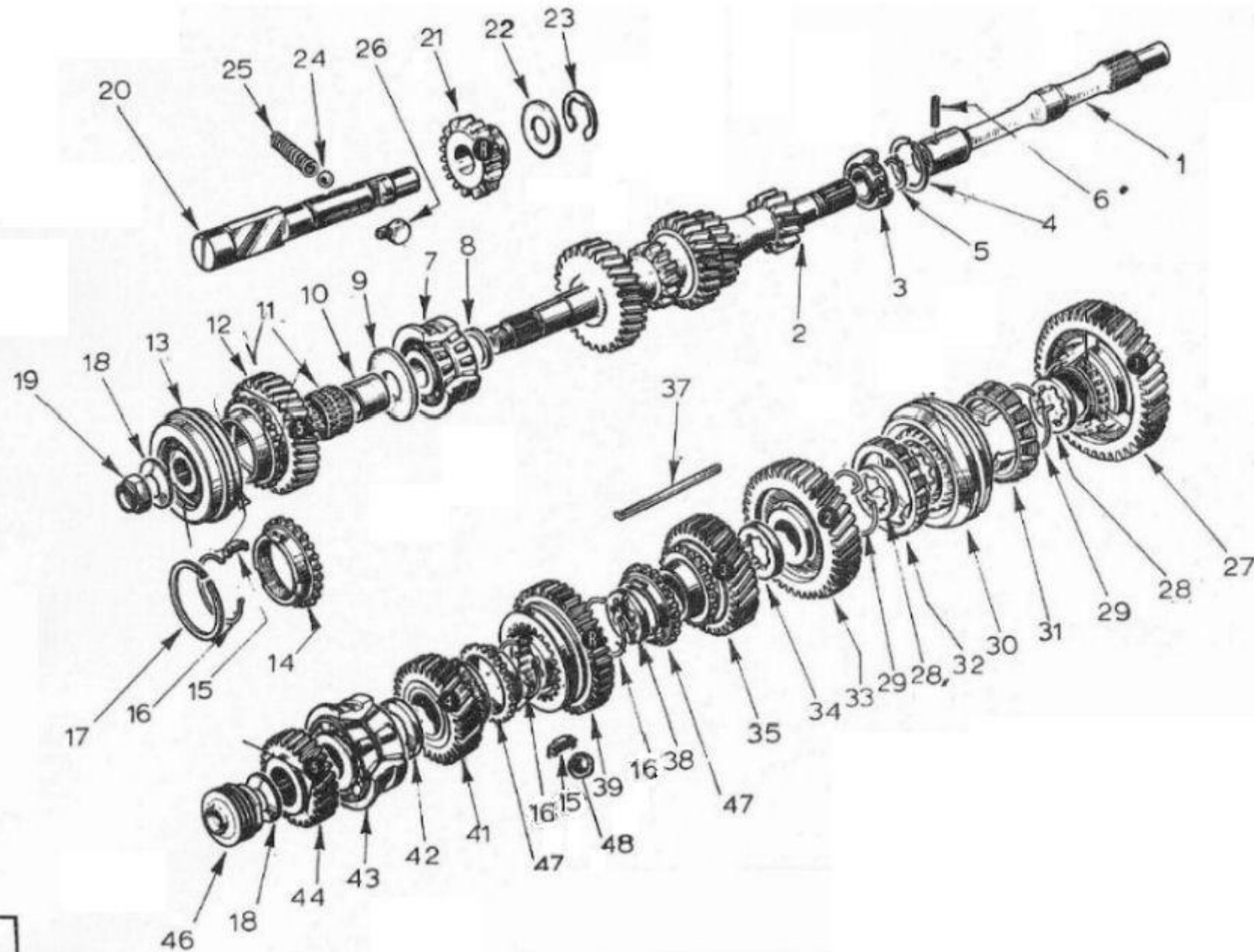

Lotus Europa TC/TCS Parts Manual - Section FH - Transmission - Gearset (365) - Page 6

Item	Lotus #	S1	S1A/B	S2	S2 Fed	TC	TC Fed	TCS	TCS F	LHD	RHD	Description	Change Point Notes Bulletin Reference
42	X046F6067Z									+	+	Shim - 3.65 mm. (As Required)	Type 365-04 Only
42	X046F6068Z									+	+	Shim - 3.70 mm. (As Required)	Type 365-04 Only
42	X046F6069Z									+	+	Shim - 3.75 mm. (As Required)	Type 365-04 Only
42	X046F6070Z									+	+	Shim - 3.80 mm. (As Required)	Type 365-04 Only
42	X046F6071Z									+	+	Shim - 3.85 mm. (As Required)	Type 365-04 Only
42	X046F6072Z									+	+	Shim - 3.90 mm. (As Required)	Type 365-04 Only
42	X046F6073Z									+	+	Shim - 3.95 mm. (As Required)	Type 365-04 Only
42	X046F6074Z									+	+	Shim - 4.00 mm. (As Required)	Type 365-04 Only
42	X046F6075Z									+	+	Shim - 4.05 mm. (As Required)	Type 365-04 Only
42	X046F6076Z									+	+	Shim - 4.10 mm. (As Required)	Type 365-04 Only
43	X046F6048Z							1	1	+	+	Bearing	
44	A074F0224Z							1	1	+	+	Gear 5th Primary	
46	A074F6111Z							1	1	+	+	Speedometer Worm Nut	
47	A074F6095Z							2	2	+	+	Synchro Ring	Type 365-04
47	A074F6168Z							2	2	+	+	Synchro Ring	Type 365-07
48	A074F6172Z							3	3	+	+	Locking Ball	Type 365-07