

EG

Lotus Europa TC/TCS Parts Manual - Section EG - Engine - Dellorto Carburetor - Page 2

Item	Lotus #	S1	S1A/B	S2	S2 Fed	TC	TC Fed	TCS	TCS F	LHD	RHD	Description	Change Point Notes Bulletin Reference
1	N026S0710W					1				+		Carburettor - Front	
1	N026S0711W					1				+		Carburettor - Rear	
1	P026S0710W					1					+	Carburettor - Front	
1	P026S0711W					1					+	Carburettor - Rear	
1	Q026S0710W						1			+		Carburettor - Front	
1	Q026S0711W						1			+		Carburettor - Rear	
1	R026S0710W						1				+	Carburettor - Front	
1	R026S0711W						1				+	Carburettor - Rear	
1	A074E6011Z					4				+	+	Choke - (30)	
1	A036E6040Z						4			+		Choke - (33)	
1	A036E6039Z						4			+	+	Choke - (32)	
2	A036E6059Z					4	4					Auxiliary Venturi	
3	A074E6013Z					4						Jet - Main (115)	
3	A036E6042Z					4	4					Jet - Main (120)	European small valve and Domestic big valve engines
3	A036E6043Z											Jet - Main (135)	
4	A036E6048Z											Jet - Idling (50)	
4	A074E6012Z											Jet - Idling (45)	
4	A036E6047Z											Jet - Idling (47)	
5	A074E6015Z					4				+		Jet - Pump (40)	
5	A036E6056Z					4	4				+	Jet - Pump (33)	
5	A036E6057Z						4			+		Jet - Pump (45)	
6	A036E6051Z					2	2			+	+	Jet - Starting (70)	
7	A036E6053Z					4				+		Emulsion Tube - Main	
7	A036E6054Z					4	4			+	+	Emulsion Tube - Main	Not Domestic small valve engines
8	A036E6055Z					2	2			+	+	Emulsion Tube - Starting	
9	A074E6014Z					4				+		Jet - Main Air Corrector (160)	
9	A036E6045Z						4			+		Jet - Main Air Corrector (130)	
9	A036E6044Z					4	4				+	Jet - Main Air Corrector (200)	
10	A036E6050Z					4	4			+		Jet - Idling Air Corrector	
10	A036E6049Z					4	4				+	Jet - Idling Air Corrector	
11	A036E6060Z					2	2			+	+	Needle Valve	
12	A036E6061Z					2	2			+		Float Assembly	

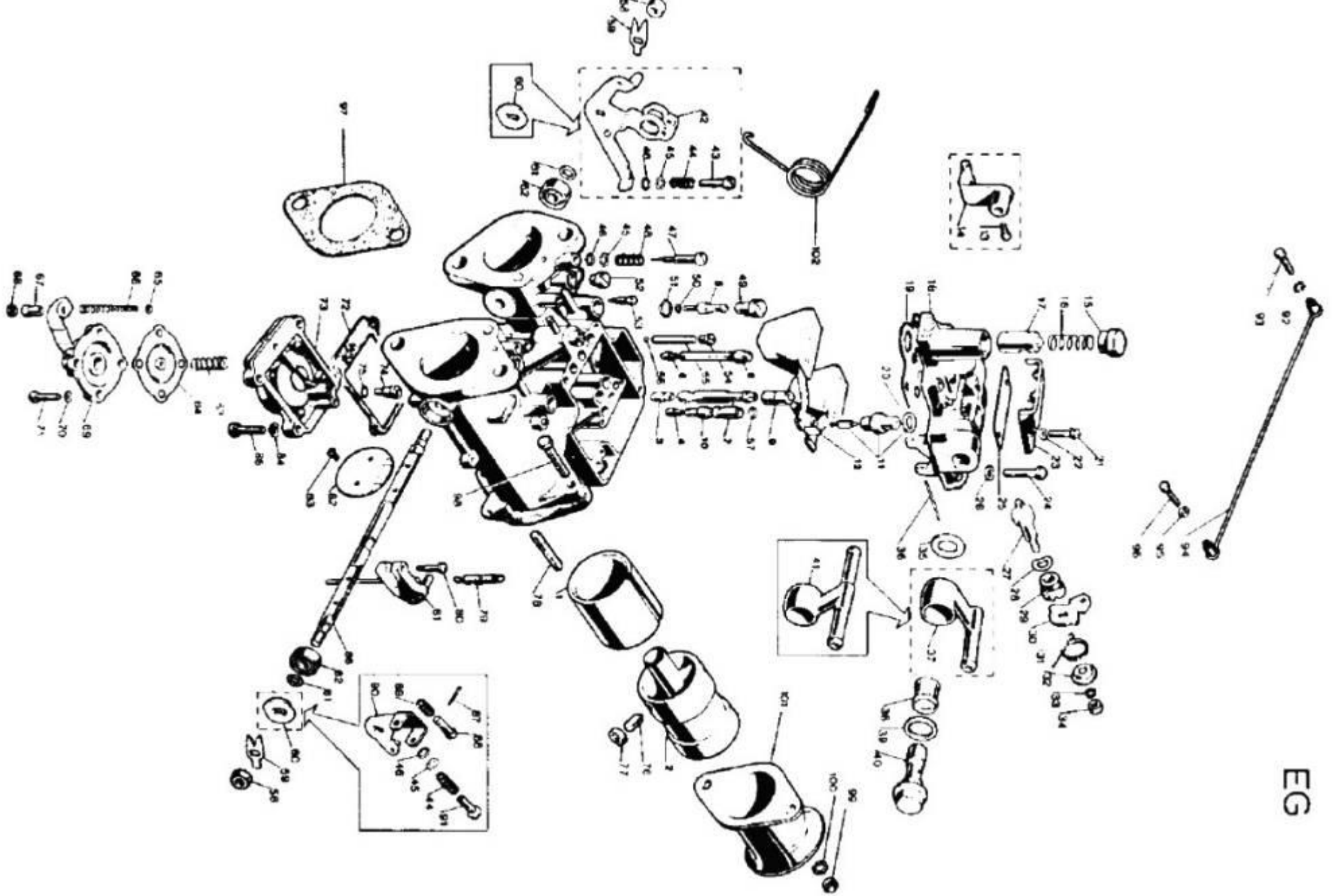

EG

Lotus Europa TC/TCS Parts Manual - Section EG - Engine - Dellorto Carburetor - Page 4

Item	Lotus #	S1	S1A/B	S2	S2 Fed	TC	TC Fed	TCS	TCS F	LHD	RHD	Description	Change Point Notes Bulletin Reference
12	A036E6062Z					2	2				+	Float Assembly	
13	A036E6063Z					1	1			+	+	Screw - Choke Cable	
14	A036E6064Z					1	1			+	+	Support - Choke Cable	
15	A036E6065Z					2	2			+	+	Plug - Starting Valve	
16	A036E6066Z					2	2			+	+	Spring - Starting Valve	
17	A036E6067Z					2	2			+	+	Starting Valve	
18	A036E6068Z					2	2			+	+	Cover - Float Chamber	
19	A036E6069Z					2	2			+	+	Float Chamber Cover Gasket	
20	A036E6070Z					2	2			+	+	Needle Valve Gasket	
21	A036E6071Z					4	4			+	+	Screw - Jet Cover	
22	A036E6072Z					4	4			+	+	Washer - Spring	
23	A036E6073Z					2	2			+	+	Cover - jet	
24	A036E6074Z					8	8			+	+	Screw - Float Chamber Cover	
25	A036E6075Z					2	2			+	+	Jet Cover Gasket	
26	A036E6076Z					8	8			+	+	Washer - Spring - Float Chamber Cover	
27	A036E6077Z					2	2			+	+	Control Shaft - Starting Valve	
28	A036E6078Z					2	2			+	+	Washer - Spring	
29	A036E6079Z					2	2			+	+	Plug - Control Shaft	
30	A036E6080Z					2	2			+	+	Control Leverm Starting Valve	
31	A036E6081Z					2	2			+	+	Return Spring	
32	A036E6082Z					2	2			+	+	Bush - Return Spring	
33	A036E6083Z					2	2			+	+	Washer - Spring	
34	A036E6084Z					2	2			+	+	Nut	
35	A036E6085Z					2	2			+	+	Banjo Union Gasket	
36	A036E6086Z					2	2			+	+	Pin - Float Assembly	
37	A036E6087Z					1	1			+	+	Union - Banjo (rear carb)	
38	A036E6088Z					2	2			+	+	Filter	
39	A036E6089Z					2	2			+	+	Banjo Plug Gasket	
40	A036E6090Z					2	2			+	+	Plug - Banjo	
41	A036E6091Z					1	1			+	+	Union - Banjo (front carb)	
42	A036E6092Z					1	1			+	+	Lever - Throttle Control	
43	A036E6093Z					1	1			+	+	Screw - Adjusting	
44	A036E6094Z					2	2			+	+	Spring - Adjusting Screw	

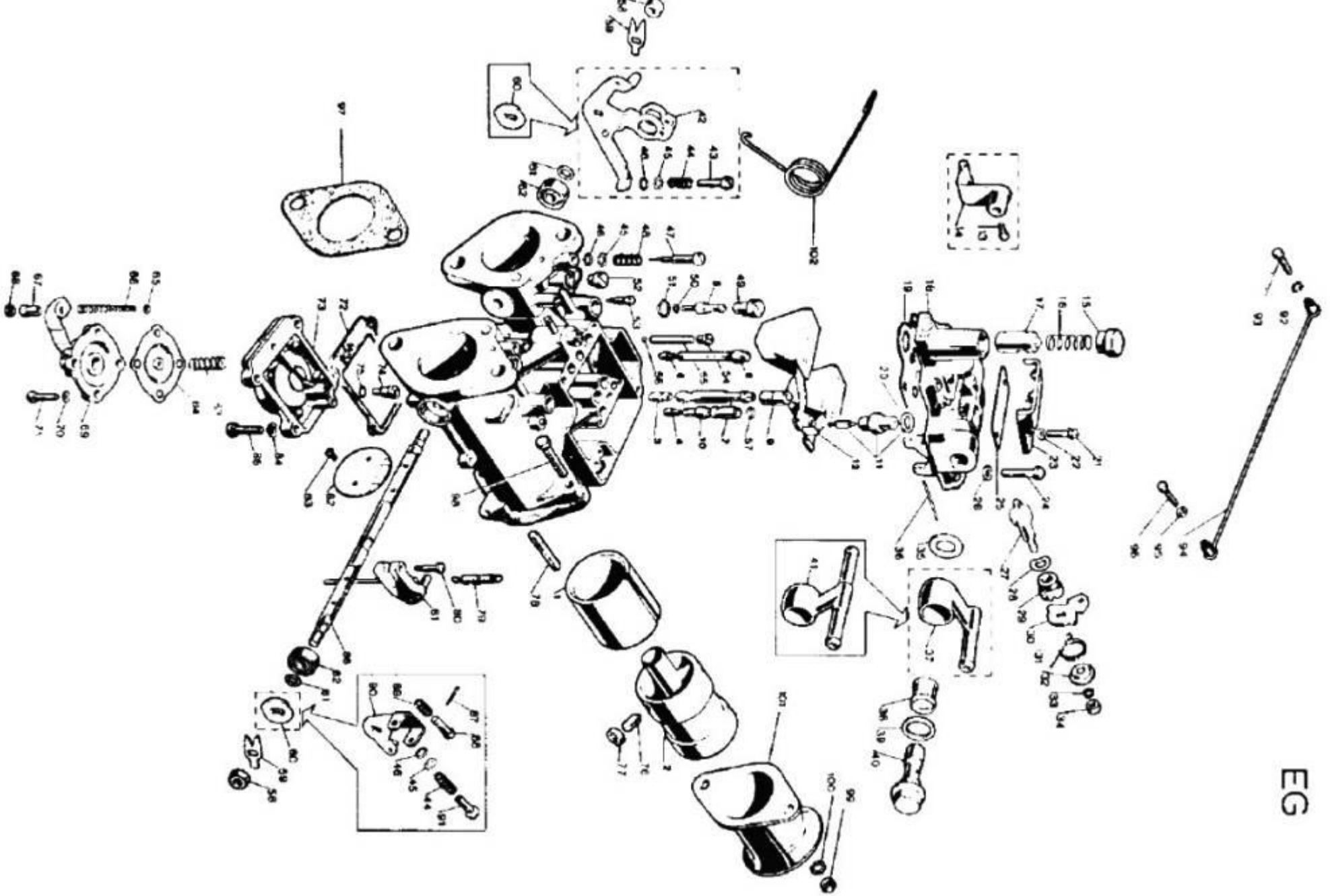

EG

Item	Lotus #	S1	S1A/B	S2	S2 Fed	TC	TC Fed	TCS	TCS F	LHD	RHD	Description	Change Point Notes Bulletin Reference
45	A036E6095Z					4	4			+	+	Washer - Plain	
46	A036E6096Z					4	4			+	+	gasket	
47	A036E6097Z					4	4			+	+	Screw - Idling Mixture	
48	A036E6098Z					4	4			+	+	Spring - Idling Mixture	
49	A036E6099Z					4	4			+	+	Plug - Pump Jet	
50	A036E6100Z					4	4			+	+	Carburetter Gasket - Pump Jet - Small	
51	A036E6101Z					4	4			+	+	Carburetter Gasket - Pump Jet - Large	
52	A036E6102Z					4	4			+	+	Plug	
53	A036E6103Z					4	4			+	+	Plug - Pressure Connection	
54	A036E6104Z					4	4			+	+	Plug - Delivery Valve Seat	
55	A036E6105Z					4	4			+	+	Stuffing - Delivery Valve	
56	A036E6106Z					4	4			+	+	Outlet Valve	
57	A036E6107Z					4	4			+	+	Carburetter Gasket	
58	A036E6108Z					4	4			+	+	Nut	
59	A036E6109Z					4	4			+	+	Plate - retaining	
60	A036E6110Z					1	1			+	+	Spacer	
61	A036E6111Z					4	4			+	+	Washer - Distance	
62	A036E6112Z					4	4			+	+	Ball Bearing	
3	A036E6113Z					2	2			+	+	Spring - Pump Diaphragm	
64	A036E6114Z					2	2			+	+	Pump - Diaphragm	
65	A036E6159Z					2	2			+	+	Washer	
66	A036E6116Z					2	2			+	+	Spring - Pump Rod	
67	A036E6117Z					2	2			+	+	Nut - Adjusting	
68	A036E6118Z					2	2			+	+	Nut - Locking	
69	A036E6160Z					2	2			+	+	Pump Cover	
70	A036E6120Z					8	8			+	+	Washer - Spring	
71	A036E6121Z					8	8			+	+	Screw - Pump Cover	
72	A036E6122Z					2	2			+	+	Carburetter Gasket - Pump Body	
73	A036E6123Z					2	2			+	+	Pump Body	
74	A036E6124Z					2	2			+	+	Inlet Valve	
75	A036E6125Z					2	2			+	+	Carburetter Gasket - Inlet Valve	
76	A036E6161Z					4	4			+	+	Screw - Auxiliary Venturi Fixing	
77	A036E6127Z					4	4			+	+	Nut - Fixing Screw	

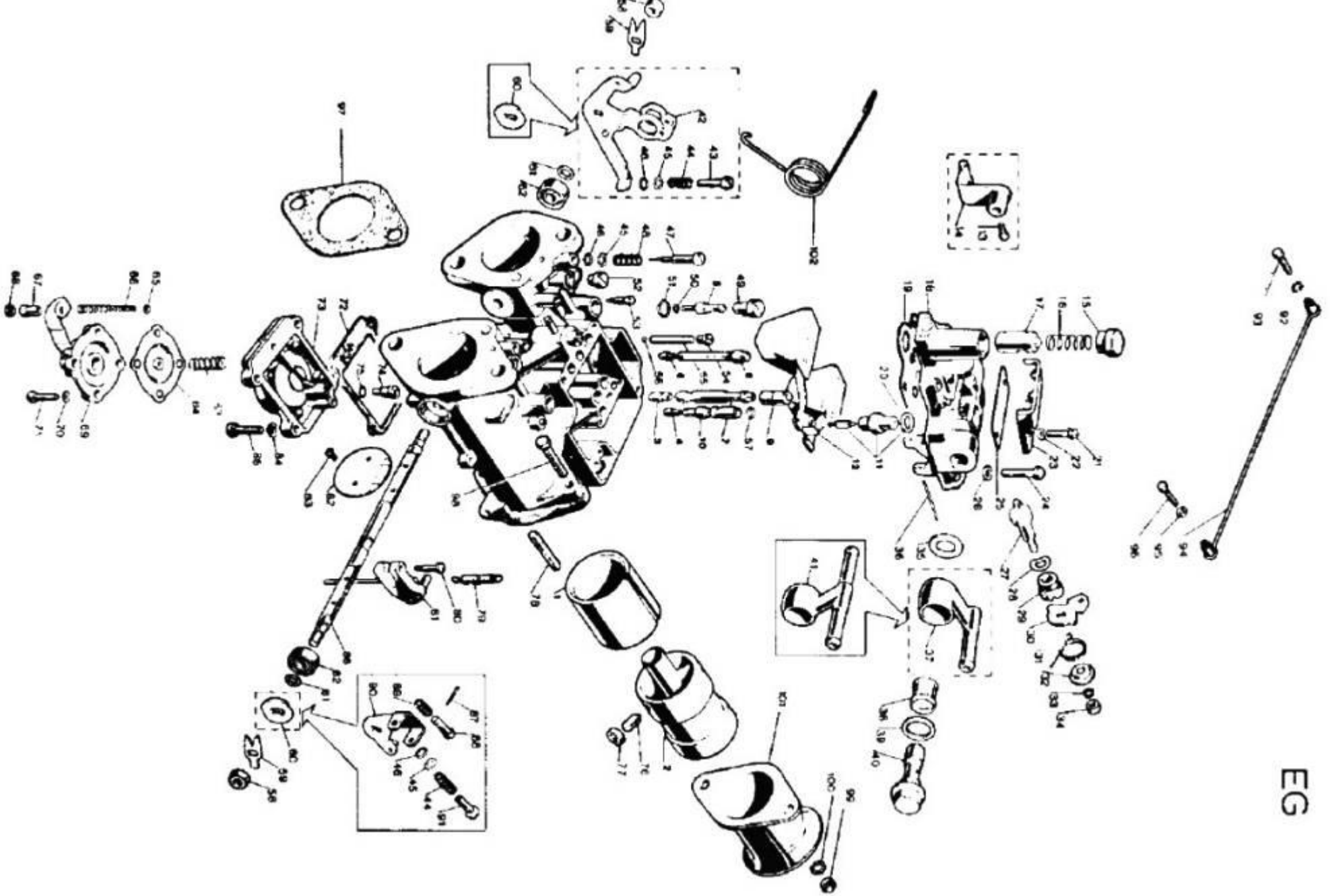

EG

Item	Lotus #	S1	S1A/B	S2	S2 Fed	TC	TC Fed	TCS	TCS F	LHD	RHD	Description	Change Point Notes Bulletin Reference
78	A036E6128Z					4	4			+	+	Stud	
79	A036E6129Z					2	2			+	+	Spring - Throttle Shaft Return	
80	A036E6130Z					2	2			+	+	Screw - Pump Control Lever	
81	A036E6162Z					2	2			+	+	Rod - Lever and Pump Control	
82	A036E6132Z					4	4			+	+	Throttle	
83	A036E6133Z					8	8			+	+	Screw - throttle	
84	A036E6134Z					8	8			+	+	Washer - Spring	
85	A036E6135Z					8	8			+	+	Screw - Pump Body	
86	A036E6136Z					2	2			+	+	Shaft - Throttle	
87	A036E6137Z					1	1			+	+	Pin - Split	
88	A036E6138Z					1	1			+	+	Pin - Control Lever	
89	A036E6139Z					1	1			+	+	Spring - Pin	
90	A036E6140Z					1	1			+	+	Control Lever	
91	A036E6141Z					1	1			+	+	Screw - Control Lever	
92	A036E6142Z					1	1			+	+	Washer - Spring	
93	A036E6143Z					1	1			+	+	Screw - Fixing	
94	A036E6144Z					1	1			+	+	Rod	
95	A036E6145Z					1	1			+	+	Washer - Plain	
96	A036E6146Z					1	1			+	+	Screw - Cable Securing	
97	A036E6147Z					4	4			+	+	Carburettor Gasket	
98	A036E6148Z					8	8			+	+	Screw - Horn Retaining	
99	A036E6149Z					8	8			+	+	Nut	
100	A036E6150Z					8	8			+	+	Washer - Spring	
101	A036E6151Z					4	4			+	+	Air Horn	
102	A074E0464Z					1	1			+	+	Spring - Throttle Return	
	A036E6163						1		1			Gasket Set	
	p/o A036E6163											Float Chamber Cover Gasket (1) p/o A036E6163	
	p/o A036E6163											Needle Valve Gasket (1) p/o A036E6163	
	p/o A036E6163											Jet Cover Gasket (1) p/o A036E6163	
	p/o A036E6163											Banjo Union Gasket (1) p/o A036E6163	
	p/o A036E6163											Bano Union Plug Gasket (1) p/o A036E6163	
	p/o A036E6163											Pump Jet Gasket (2) p/o A036E6163	
	p/o A036E6163											Pump Jet Plug Gasket (2) p/o A036E6163	



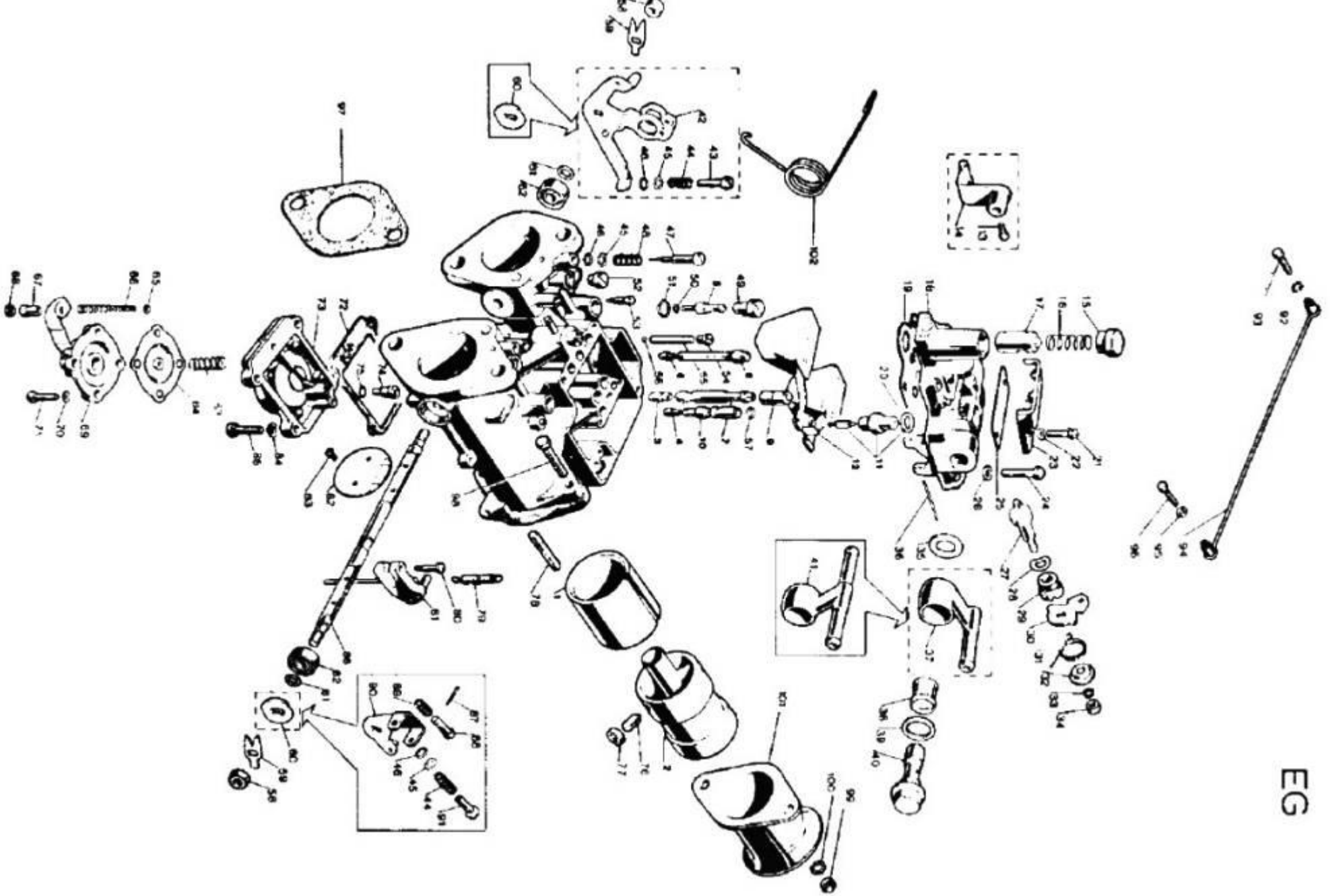

EG

Lotus Europa TC/TCS Parts Manual - Section EG - Engine - Dellorto Carburetor - Page 10

Item	Lotus #	S1	S1A/B	S2	S2 Fed	TC	TC Fed	TCS	TCS F	LHD	RHD	Description	Change Point Notes Bulletin Reference
	p/o A036E6163											Idling Air Jet Gasket (2) p/o A036E6163	
F 1	M026S0710W						1	1				Carburettor - Front	
F 1	M026S0711W						1	1				Carburettor - Rear	
F 1	A036S6173Z						2	2				Needle - Metering (Non-adjustable-B1G)	
F 2	A036S6023Z						2	2				Screw - Locking	
F 3	A036S6024Z						2	2				Diaphragm	
F 4	A036S6025Z						2	2				Retaining Ring	
F 5	A036S6026Z						8	8				Screw	
F 6	A036S6191Z						2	2				Spring - Air Valve (light blue)	
F 7	A036S6029Z						8	8				Screw - Top Retaining - c/w Washer	
F 8	A036S6181W						2	2				Damper Assembly	
F 9	A036S6192Z						2	2				O Ring - Damper Assembly	
F 10	A036S6035Z						4	4				Screw - Throttle Attachment	
F 11	A036S6036Z						1	1				Throttle Spindle - Front Carb	
F 12	A036S6037Z						2	2				Throttle	
F 13	A036S6040Z						1	1				Lever - Floating - Front Carb	
F 14	A036S6041Z						2	2				Bush	
F 15	A036S6042Z						2	2				Lockwasher	
F 16	A036S6043Z						2	2				Washer - Plain	
F 17	A036S6044Z						2	2				Washer - Shakeproof	
F 18	A036S6045Z						2	2				Nut	
F 19	A036S6187Z						1	1				Starter Assembly Complete	
F 19	A036S6074Z						2	2				Screw - Attachment - Starter Assembly	
F 19	A036S6149Z						2	2				Washer - Shakeproof - Starter Assembly	
F 20	A036S6052Z						1	1				Bracket - Starter Control - c/w Clip	
F 21	A036S6053Z						1	1				Clip	
F 21	A036S6054Z						1	1				Screw - Attachment - Clip	
F 22	A036S6057Z						1	1				Lever - Throttle - Stop and Fast Idle (front carb)	
F 23	A036S6058Z						1	1				Screw - Fast Idle	
F 24	A036S6059Z						1	1				Locknut - Fast Idle	
F 25	A036S6051Z						2	2				Screw - Throttle Stop	
F 26	A036S6050Z						2	2				Spring	
F 27	A036S6125Z						4	4				Seal - Throttle Spindle	

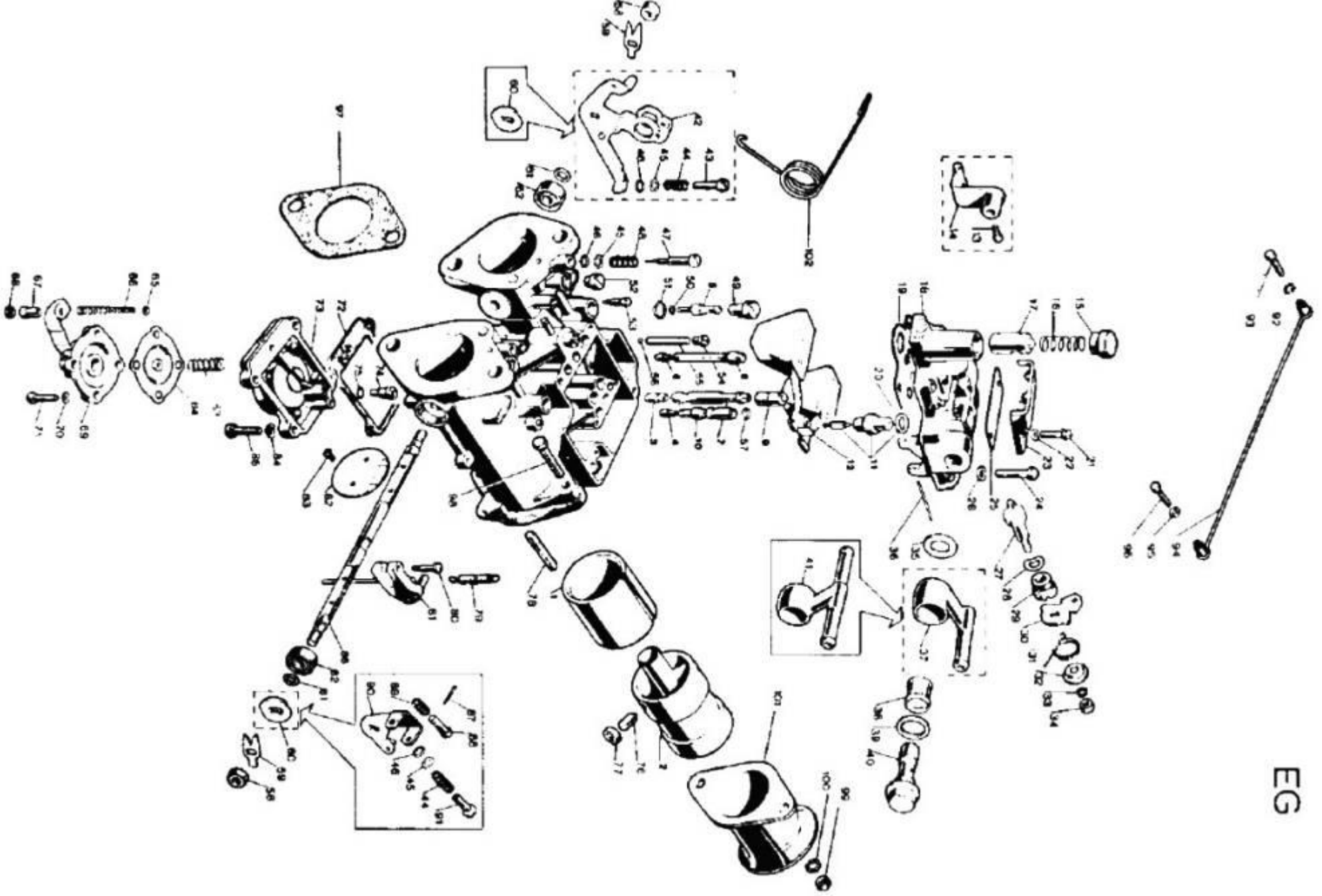

EG

Item	Lotus #	S1	S1A/B	S2	S2 Fed	TC	TC Fed	TCS	TCS F	LHD	RHD	Description	Change Point Notes Bulletin Reference
F 28	A036S6056Z						2	2				Spring - throttle Return	
F 29	A036S6060Z						1	1				Tabwasher	
F 30	A036S6061Z						1	1				Nut - Extension	
F 31	A036S6062Z						2	2				Coupling	
F 31	A036S6157Z						4	4				Screw - Attaching - Coupling	
F 31	A036S6159Z						4	4				Washer - Attaching - Coupling	
F 31	A036S6158Z						4	4				Nut - Attaching - Coupling	
F 32	A036S6068Z						1	1				Assembly - Coupling Spindle and Throttle Lever - comprising:	
F 33	A036S6063Z						1	1				Lever - Throttle p/o Assembly - Coupling Spindle and Throttle Lever	
F 34	A036S6065Z						1	1				Spindle - Coupling p/o Assembly - Coupling Spindle and Throttle Lever	
F 35	A036S6066Z						2	2				Washer p/o Assembly - Coupling Spindle and Throttle Lever	
F 36	A036S6067Z						2	2				Washer - Starlock p/o Assembly - Coupling Spindle and Throttle Lever	
F 37	A036S6185W						1	1				Valve - By-pass	
F 38	A907E6139Z						1	1				gasket	
F 38	A036S6087Z						3	3				Screw - Attaching - c/w Washer	
F 40	A036S6186W						2	2				Temperature Compensator Assembly	
F 41	A036S6123Z						2	2				Seal	
F 42	A036S6124Z						2	2				Seal	
F 42	A036S6122Z						4	4				Screw - Attaching - Seal	
F 42	A036S6141Z						4	4				Washer - Shakeproof - Seal	
F 43	A036S6113Z						2	2				Screw - Trimmer	
F 44	A036S6114Z						2	2				Spring	
F 45	A036S6086X						2	2				Floatchamber	
F 45	A036S6088Z						8	8				Screw - Attaching - (long) - c/w Washer - Floatchamber	
F 45	A036S6087Z						4	4				Screw - Attaching - (short) - c/w Washer - Floatchamber	
F 46	A036S6082Z						2	2				Gasket	
F 47	A907E6141Z						2	2				Float Arm Assembly	

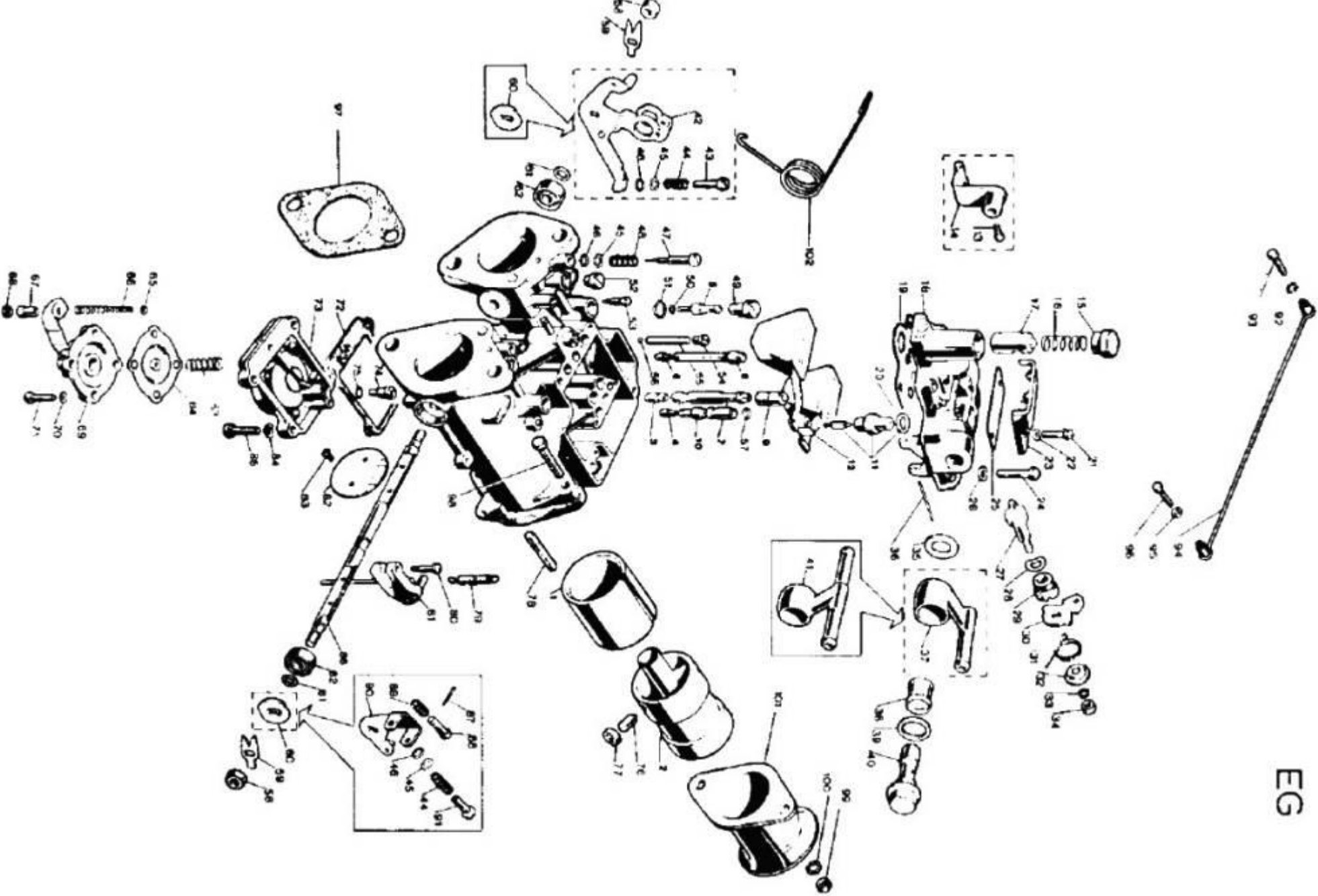

EG

Lotus Europa TC/TCS Parts Manual - Section EG - Engine - Dellorto Carburetor - Page 14

Item	Lotus #	S1	S1A/B	S2	S2 Fed	TC	TC Fed	TCS	TCS F	LHD	RHD	Description	Change Point Notes Bulletin Reference
F 48	A036S6085Z						2	2				Pivot	
F 49	A036S6130Z						2	2				Valve - Needle	
F 50	A036S6083Z						2	2				Washer - Needle Valve	
F 51	A036S6147Z						2	2				Plug - Floatchamber - c/w O Ring	
F 52	A036S6090Z						2	2				O ring	
F 53	A036S6188Z						1	1				Throttle Spindle - Rear Carb.	
F 54	A036S6189Z						1	1				Lever - Throttle Stop and Fast Idle (Rear Carb)	
F 55	A036S6190Z						1	1				Lever - Floating (Rear Carb)	
F 56	A036S6130Z						2	2				Adaptor - Ignition	
F	A036S6162Z											Gasket Set - 12,000 miles (20,000 km) ( As required)	
F	A036S6163Z											Gasket Set - 24,000 miles (40,000 km) ( As required)	
F	A036S6164Z											Gasket Set - Carburettors to ( As required)	