

Lotus Europa TC/TCS Parts Manual - Section EA - Engine - Block - Page 2

Item	Lotus #	S1	S1A/B	S2	S2 Fed	TC	TC Fed	TCS	TCS F	LHD	RHD	Description	Change Point Notes Bulletin Reference
1	V026E0701W					1				+		Engine Assembly	
1	Y026E0701W					1					+	Engine Assembly	
1	R026E0701W							1		+		Engine Assembly	
1	Z026E0701W							1			+	Engine Assembly	
1	S026E0701W						1		1			Engine Assembly	
1	S026E0701W					1	1	1	1			Short Engine Assembly	
1	C046E0708S					1	1	1	1			Cylinder Block - Short Engine Assembly	
1	X026E0384Z					1	1	1	1			Retainer - Short Engine Assembly	
1	A026E6032Z					1	1	1	1			Plug - Water Drain - Short Engine Assembly	
1	A026E6031Z					2	2	2	2			Plug Oil Gallery - Short Engine Assembly	
1	B026E0330Z					1	1	1	1			Crankshaft - Short Engine Assembly	
1	X026E0015Z					1	1	1	1			Sprocket - Crankshaft - Short Engine Assembly	
1	C026E0340W					4	4	4	4			Rod - Connecting - Short Engine Assembly	
1	C026E0712A					4	4	4	4			Piston Assembly - Short Engine Assembly	
1	X026E0352Z					1	1	1	1			Jackshaft - Short Engine Assembly	
1	A026E6083Z					1	1	1	1			Oil Sump	
2	A036E6164Z					1	1	1	1			Oil Sump Drain Plug	
3	A036E6156Z					1	1	1	1			Washer - Oil Sump Drain Plug	
4	A026E6085Z					1	1	1	1			Oil Sump L/H Gasket	
4	A026E6084Z					1	1	1	1			Oil Sump R/H Gasket	
5	A026E6082Z					1	1	1	1			Seal - Oil Sump - Front	
6	A026E6086Z					1	1	1	1			Seal - Oil Sump - Rear	
7	A026E6064Z					18	18	18	18			Bolt - Oil Sump to Cylinder Block	
8	A026E6117Z					18	18	18	18			Washer - Oil Sump to Cylinder Block	
9	X026E0384Z					1	1	1	1			Retainer - Rear Oil Seal	
10	X026X0387Z					1	1	1	1			Rear Oil Seal Retainer Gasket	
11	A026E6047Z					4	4	4	4			Bolt - Rear Oil Seal Retainer	
12	A026E6091Z					4	4	4	4			Washer - Rear Oil Seal Retainer	
13	C026E0708S					1	1	1	1			Cylinder Block	
14	A026E6090Z					3	3	3	3			Plug - Water Jacket	
15	A026E6032Z					1	1	1	1			Plug - Water Drain	
16	A026E6031Z					2	2	2	2			Plug - Oil gallery	
17	A036E6167Z					1	1	1	1			Oil Pressure Tube Adaptor	

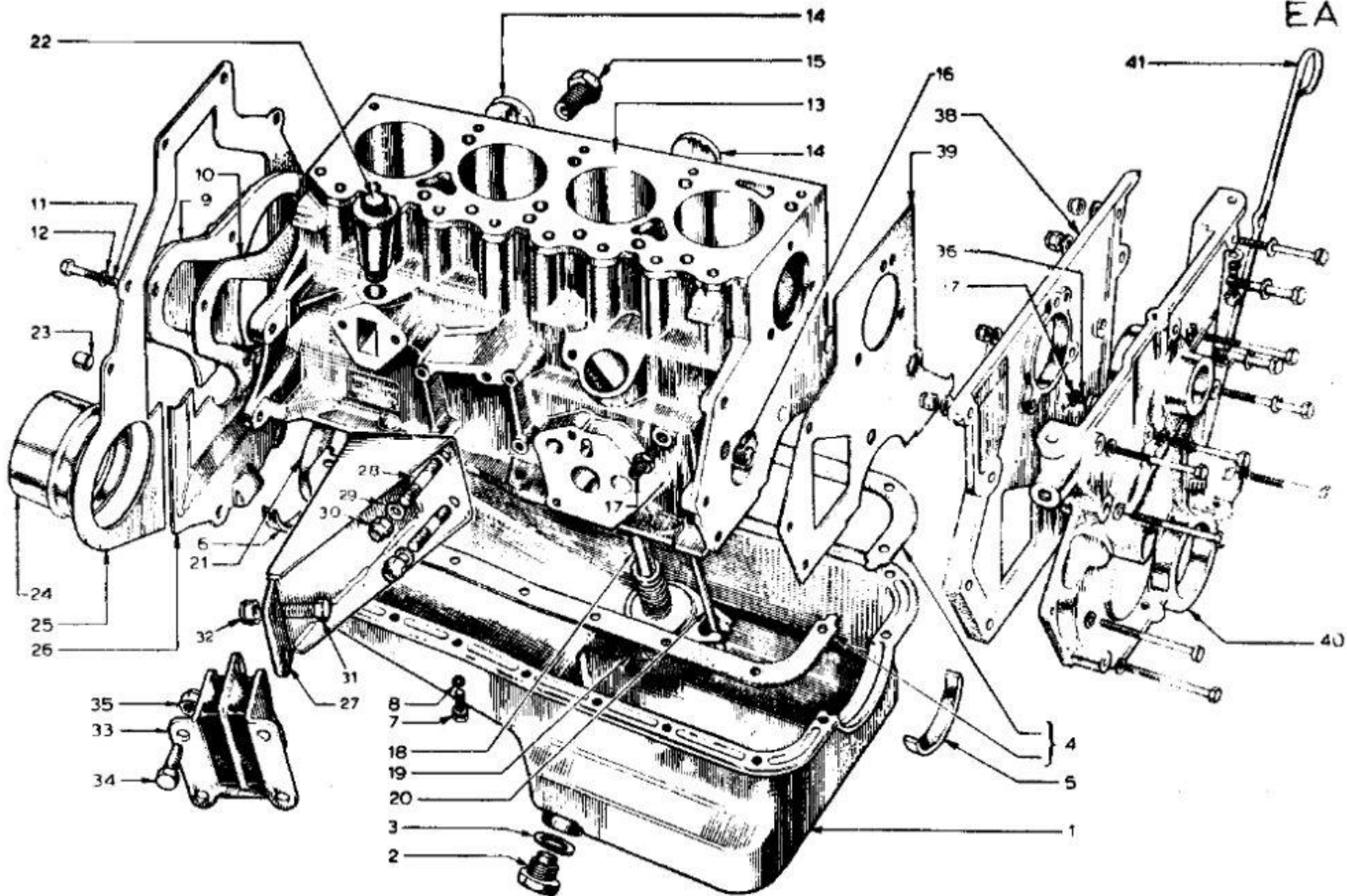

Lotus Europa TC/TCS Parts Manual - Section EA - Engine - Block - Page 4

Item	Lotus #	S1	S1A/B	S2	S2 Fed	TC	TC Fed	TCS	TCS F	LHD	RHD	Description	Change Point Notes Bulletin Reference
18	A026E6089W					1	1	1	1			Tube - Oil Intake	
19	A026E6088W					1	1	1	1			Screen Assembly - Oil Pump	
20	A026E6087W					1	1	1	1			Tube - Return	
21	A036E6166Z					1	1	1	1			Crankshaft Seal - Rear	
22	X026E0034Z					1	1	1	1			Connector - Cylinder Block Breather	
23	A026E6106Z					2	2	2	2			Dowel Pin - Block to Clutch Housing	
24	A026E6125Z					1	1	1	1			Cover - Starter Motor Drive	
25	A026E6018Z					1	1	1	1			Cover - Flywheel - Upper	
26	A036E6168Z					1	1	1	1			Cover - Flywheel - Lower	
27	C074E0481Z					1	1	1	1			Bracket - Engine Mounting L/H	
27	C074E0480Z					1	1	1	1			Bracket - Engine Mounting R/H	
28	A074E0490Z					8	8	8	8			Stud - Mounting bracket	
29	118					8	8	8	8			Washer - Plain	
30	A074E6016Z					8	8	8	8			Nut	
31	A036E6169Z					4	4	4	4			Bolt - Bracket to Engine Mounting	
32	214					4	4	4	4			Nut - Bracket to Engine Mounting	
33	A074E0549Z					2	2	2	2			Engine Mounting	
34	10					8	8	8	8			Bolt - Engine Mounting	
35	221					8	8	8	8			Nut - Engine Mounting	
36	A026E6045Z					1	1	1	1			Set screw	
37	A036E6170Z					1	1	1	1			Washer	
38	X026E0004Z					1	1	1	1			Backplate - Timing Case	
39	X026E0005Z					1	1	1	1			Backplate - Timing Case Gasket	
39	A074E0705W					1	1	1	1			Cover Assembly - Timing Case	Comprising: 1 of A026E6000W and 1 of X026E0041Z
40	A074E0361Y					1	1	1	1			Cover - Timing Case	
40	X026E0734W					1	1	1	1			Cover - Timing Case - c/w Oil Tube	
40	A026E6030Z					1	1	1	1			Tube - Oil	
40	A074E6004Z					1	1	1	1			Plug - Pressure	
40	12					1	1	1	1			Set Screw - Timing Case to Head	
40	15					1	1	1	1			Washer Spring - Timing Case to Head	
40	118					1	1	1	1			Washer Plain - Timing Case to Head	

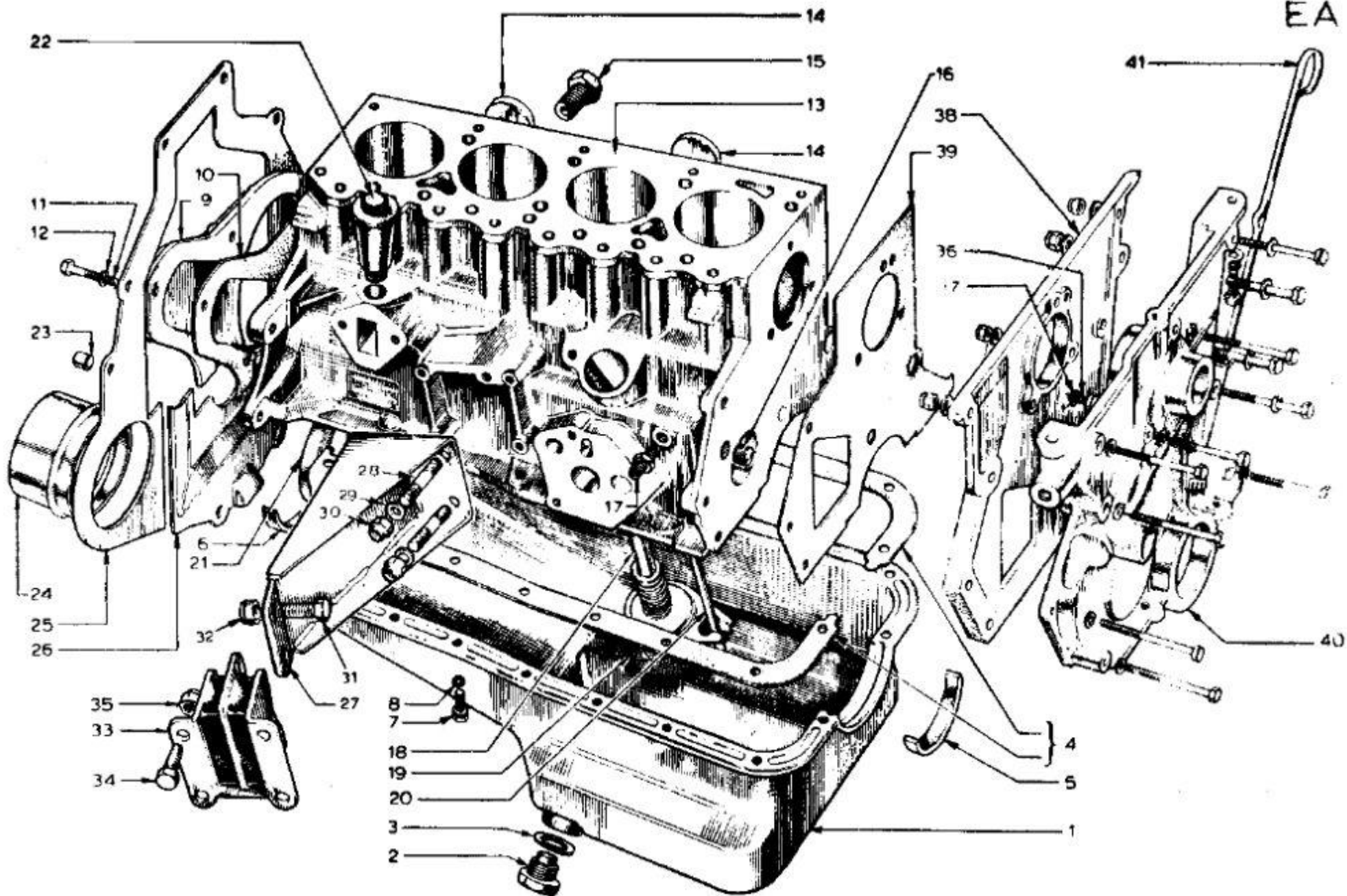

Lotus Europa TC/TCS Parts Manual - Section EA - Engine - Block - Page 6

Item	Lotus #	S1	S1A/B	S2	S2 Fed	TC	TC Fed	TCS	TCS F	LHD	RHD	Description	Change Point Notes Bulletin Reference
40	6BL					3	3	3	3			Bolt - Timing Case to Block	
40	A026E6057Z					6	6	6	6			Bolt 1/4 ins. UNC X 2 1/4 ins. - Timing Case to Block	
40	107					6	6	6	6			Washer - Spring - Timing Case to Block	
40	A026E6050Z					6	6	6	6			Washer - Plain - Timing Case to Block	
40	208					3	3	3	3			Nut - Timing Case to Block	
40	A026E6121Z					1	1	1	1			Bolt - 5/16 ins. UNC x 2 1/4 ins. - Timing Case to Block	
40	115					1	1	1	1			Washer - Spring - Timing Case to Block	
40	178					1	1	1	1			Bolt Timing Case to Block	
40	118					1	1	1	1			Washer - Plain Timing Case to Block	
40	213					1	1	1	1			Nut Timing Case to Block	
41	A026E0383B					1	1	1	1			Dip Stick	