

CA

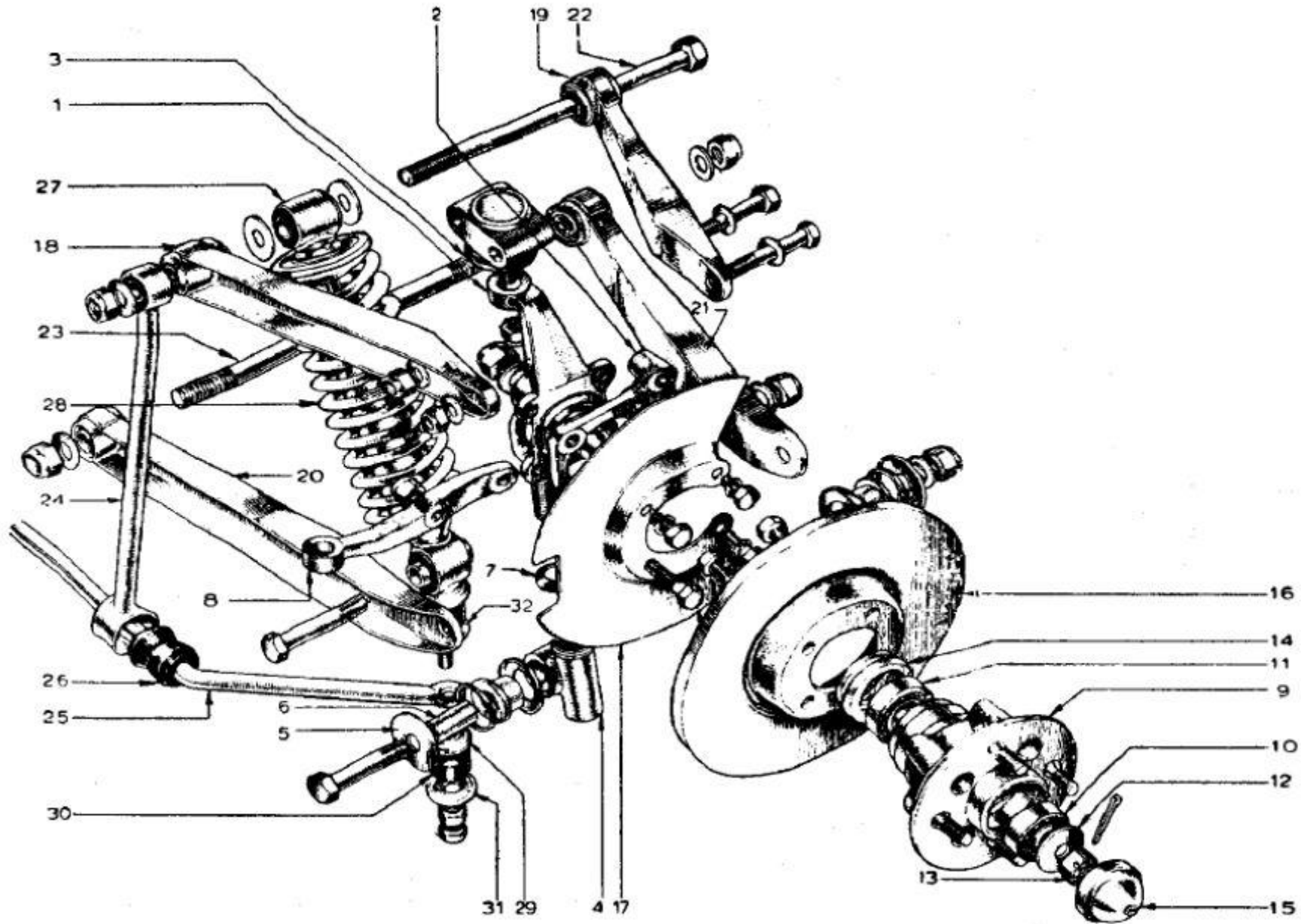

Lotus Europa TC/TCS Parts Manual - Section CA - Suspension - Front - Page 2

Item	Lotus #	S1	S1A/B	S2	S2 Fed	TC	TC Fed	TCS	TCS F	LHD	RHD	Description	Change Point Notes Bulletin Reference
1	X036C6006Z					1	1	1	1			Vertical Link L/H	
1	X036C6005Z					1	1	1	1			Vertical Link R/H	
1	X036C6008Z					2	2	2	2			Stub Axle (Front)	
1	X036C6033Z					2	2	2	2			Nut - Nyloc or Stover - Stub Axle to Vertical Link or 036C6033	1/2" x 20 TPI, 3/4" head
1	X036C6034Z					2	2	2	2			Washer - Stub Axle to Vertical Link or 036C6034	
2	X036C6022Z					1	1	1	1			Caliper Mounting Plate L/H	
2	X036C6021Z					1	1	1	1			Caliper Mounting Plate R/H	
3	X036C6007Z					2	2	2	2			Ball Joint Assembly Upper	
3	218					2	2	2	2			Nut - Ball Joint to Vertical Link	
4	X036C6026W					1	1	1	1			Lower Trunnion Assembly L/H	
4	X036C6025W					1	1	1	1			Lower Trunnion Assembly R/H	
5	X036C6032Z					4	4	4	4			Washer - Lower Trunnion	
5	X036C6029Z					4	4	4	4			Washer - Lower Trunnion	
5	X050B6005Z					4	4	4	4			Bush - Lower Trunnion	
6	X036C6031Z					2	2	2	2			Sleeve - Lower Trunnion	
6	X036C6030Z					4	4	4	4			Seal - Lower Trunnion	
6	33					2	2	2	2			Bolt - Lower Trunnion to Wishbone	
6	128					2	2	2	2			Washer - Lower Trunnion to Wishbone	
6	218					2	2	2	2			Nut - Lower Trunnion to Wishbone	
7	X036C6028Z					2	2	2	2			Seal - Lower Trunnion	
8	X036H6001Z					1	1	1	1			Steering Arm L/H	
8	X036H6000Z					1	1	1	1			Steering Arm R/H	
9	X036C6014Z					2	2	2	2			Front Hub	
9	X036C6015Z					8	8	8	8			Wheel Stud	Thread: 3/8-24, Knurl Dia.: .519", Length: 1.237", Shoulder Length: .455"
10	X036C6016Z					2	2	2	2			Wheel Bearing - Front Outer	
11	X036C6017Z					2	2	2	2			Wheel Bearing - Front Inner	
12	X036C6009Z					2	2	2	2			D Washer - Hub to Stub Axle	
13	X036C6010Z					2	2	2	2			Castellated Nut - Hub to Stub Axle	
13	W0087					2	2	2	2			Split Pin - Hub to Stub Axle	
14	X036C6018Z					2	2	2	2			Oil Seal - Front Hub	
15	X036C6013Z					2	2	2	2			Grease Cap	

CA

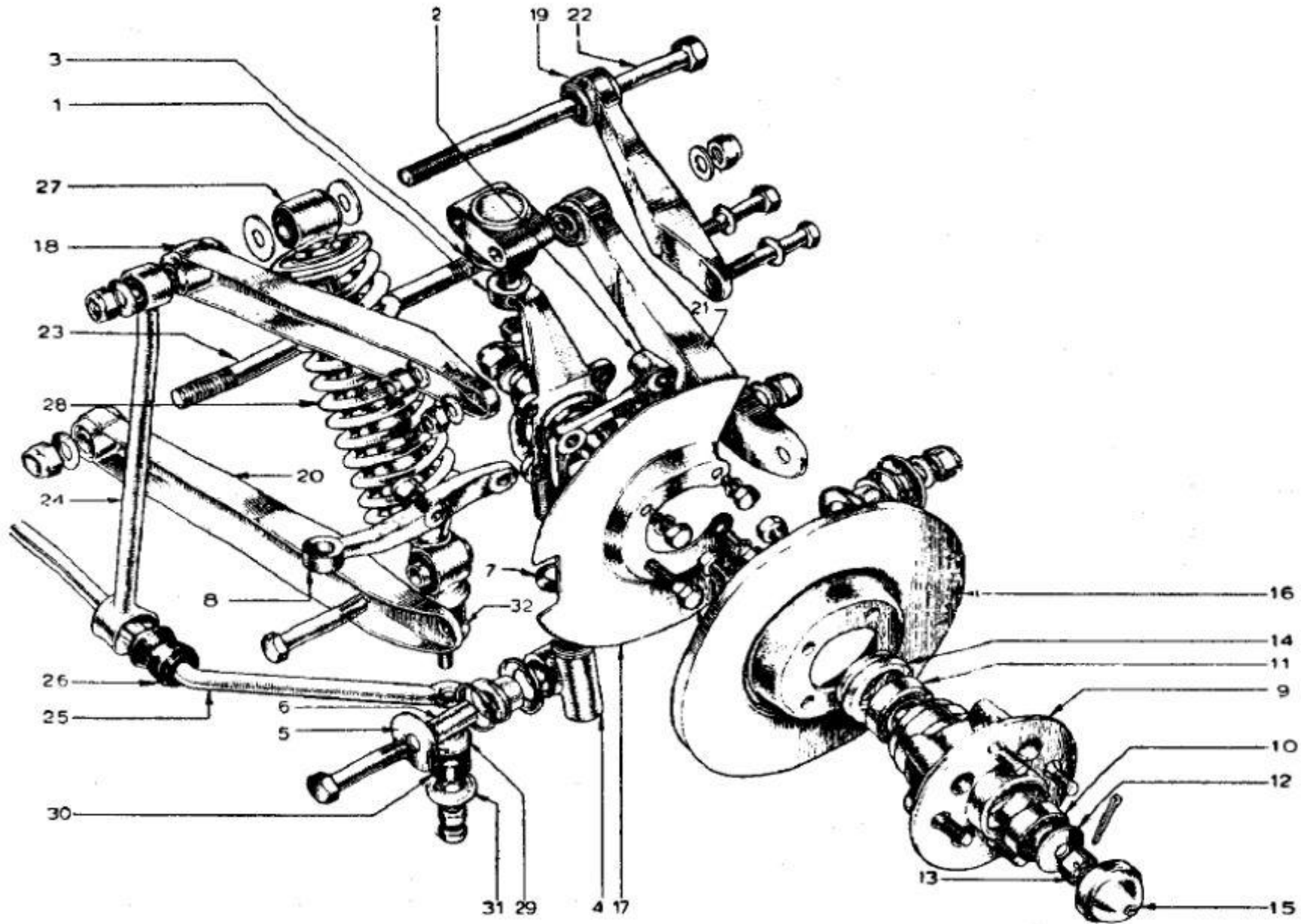

Lotus Europa TC/TCS Parts Manual - Section CA - Suspension - Front - Page 4

Item	Lotus #	S1	S1A/B	S2	S2 Fed	TC	TC Fed	TCS	TCS F	LHD	RHD	Description	Change Point Notes Bulletin Reference
16	X036J6008Z					2	2	2	2			Brake Disc	
16	X036J6009Z					8	8	8	8			Bolt - Brake Disc to Front Hub	9/16"
16	X036J6010Z					8	8	8	8			Washer - Brake Disc to Front Hub	9/16"
17	X036C6020Z					1	1	1	1			Dust Cover - L/H	
17	X036C6019Z					1	1	1	1			Dust Cover - R/H	
17	X036C6023Z					2	2	2	2			Bolt - Dust Cover - Caliper Mounting Plate & Steering Arm to Vertical Link	9/16" x 2.25" long with 1" thread length
17	X036C6024Z					8	8	8	8			Bolt - Dust Cover - Caliper Mounting Plate to Vertical Link	1/2" x 3/4" long (add 1/2" split washer)
18	A046C0093Z					1	1	1	1			Wishbone - Top Leading L/H	
18	Z046C0094Z					1	1	1	1			Wishbone - Top Leading R/H	
19	A065C0095Z					1	1	1	1			Wishbone - Top Trailing L/H	
19	A065C0096Z					1	1	1	1			Wishbone - Top Trailing R/H	
20	A065C0043Z					2	2	2	2			Wishbone - Bottom Leading L/H	
21	A065C0044Z					2	2	2	2			Wishbone - Bottom Leading R/H	
21	X036C6004Z					8	8	8	8			Bush - Wishbone	
21	XUFB0854					2	2	2	2			Bolt - Damper to Wishbone (Lower)	
21	139					4	4	4	4			Washer - Lower Wishbone to Damper	
21	219					2	2	2	2			Nut - Lower Wishbone to Damper	
21	18					4	4	4	4			Bolt - Upper Wishbone to Damper	
21	118					8	8	8	8			Washer - Upper Wishbone to Damper	
21	211					4	4	4	4			Nut - Upper Wishbone to Damper	
22	B046C0092Z					2	2	2	2			Pin - Upper Fulcrum	
22	219					2	2	2	2			Nut - Securing - Upper Fulcrum	
22	128F					2	2	2	2			Washer - Upper Fulcrum	
23	C074C0115Z					2	2	2	2			Pin Lower Fulcrum	
23	219					4	4	4	4			Nut - Securing - Lower Fulcrum	
23	128F					4	4	4	4			Washer - Lower Fulcrum	
24	X054C0005Z					2	2	2	2			Link - Anit Roll Bar	
24	X046C6001Z					2	2	2	2			Bush - Anti Roll Bar Link	
25	B074C0003Z					1	1	1	1			Bar - Anti Roll	
26	X036C6027Z					2	2	2	2			Bush - Anti Roll Bar to Link	
27	A074C0730W					2	2	2	2			Assembly - Damper/Spring	
28	A074C0010Z					2	2	2	2			Spring	

CA

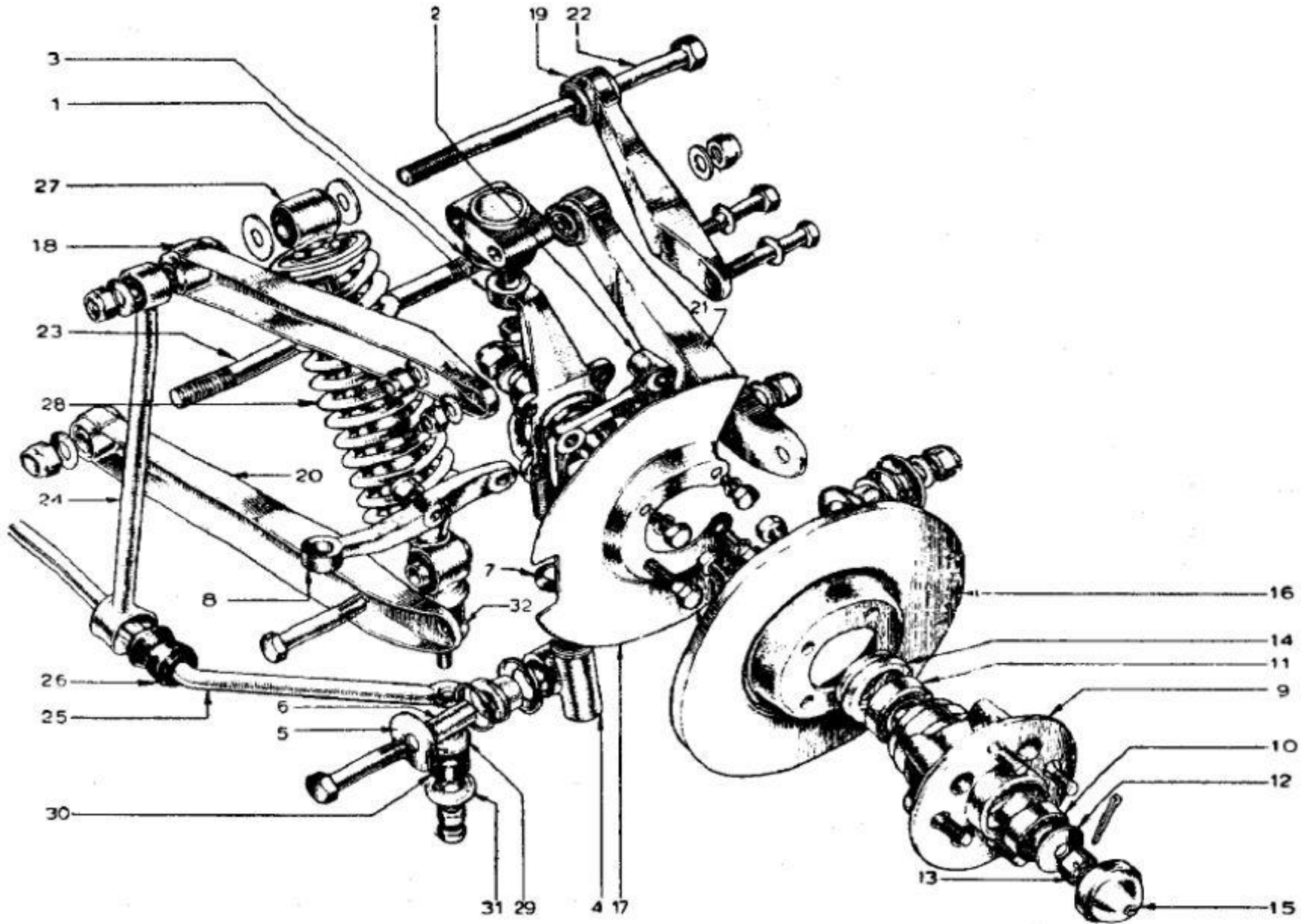

Lotus Europa TC/TCS Parts Manual - Section CA - Suspension - Front - Page 6

Item	Lotus #	S1	S1A/B	S2	S2 Fed	TC	TC Fed	TCS	TCS F	LHD	RHD	Description	Change Point Notes Bulletin Reference
29	X036C6000Z					2	2	2	2			Plate - Damper to Anti Roll Bar	
30	X046C6000Z					4	4	4	4			Rubber - Damper to Anti Roll Bar	
31	X036C6003Z					2	2	2	2			Retainer - Damper to Anti Roll Bar (Lower)	
32	X036C6001Z					2	2	2	2			Retainer - Damper to Anti Roll Bar (Upper)	
32	AUFN060F					2	2	2	2			Nut - Damper bottom	
32	216					2	2	2	2			Nut - Securing - Retainer - Upper	