

Lotus Europa TC/TCS Parts Manual - Section BB - Body - Attachments - Page 2

Item	Lotus #	S1	S1A/B	S2	S2 Fed	TC	TC Fed	TCS	TCS F	LHD	RHD	Description	Change Point Notes Bulletin Reference
1	X046B6011Z					1	1	1	1			Front Bumper	
2	X046B6012Z					1	1	1	1			Rear Bumper	
2	436B					2	2	2	2			Rivet - Blanking - Bumper	
2	453A					8	8	8	8			Bumper Bolt - Bumper Mounting	
2	116AA					8	8	8	8			Fibre Washer - Bumper Mounting	
2	118					8	8	8	8			Washer - Plain - Bumper Mounting	
2	AA4					8	8	8	8			Washer - Spring - Bumper Mounting	
2	214A					8	8	8	8			Nut - Bumper Mounting	
3	X054B1535Z					1	1	1	1			Stay - Bonnet Lid	
4	X046B1131Z					1	1	1	1			Stay - Engine Compartment Lid	
5	X036B6010Z					4	4	4	4			Gromet - Stay Pivot	
6	X0541673Z					2	2	2	2			Clip - Stay Pivot	
7	X054B1652Z					1	1	1	1			Strip - Foam - Bonnet Lid	
8	X026B0371Z					1	1	1	1			Gromet - Handbrake Fixing Access	
9	X036K0068Z					1	1	1	1			Seal - Handbrake Access Aperature	
10	A054J6005Z					2	2	2	2			Gromet - Body Attaching Bolt Access	
11	148					2	2	2	2			Bolt - Bonnet Securing	
11	X054B6107Z					2	2	2	2			Rubber Washer - Bonnet Fixing	1" OD x 11/32" ID x 1/8" Thick
11	118					2	2	2	2			Washer - Bonnet Securing	
12	X046B6112Z					1	1	1	1			Lock - Bonnet	
13	X046B1362Z					1	1	1	1			Tab - Bonnet Lock	
14	A046B1368Z					1	1	1	1			Plate - Strike - Bonnet Lock	
15	A074U0057Z					1	1	1	1			Packing - Bonnet Lock	
16	A074B2109Z					1	1	1	1			Seal - Bonnet Lock	
17	D074B1368Z					1	1	1	1			Plate - Locking - Bonnet Lock	
17	337					2	2	2	2			Screw - Securing - Plate - Locking - Bonnet Lock	
18	X046B6113Z					4	4	4	4			Buffer - Bonnet and Engine Compartment Lid	
18	13C					2	2	2	2			Bolt - Bonnet Buffer	
18	14A					2	2	2	2			Bolt - Engine Compartment Lid Buffer	
18	119					8	8	8	8			Washer - Plain - Engine Compartment Lid Buffer	
18	116					4	4	4	4			Washer - Shakeproof - Engine Compartment Lid Buffer	
18	209A					4	4	4	4			Nut - Engine Compartment Lid Buffer	
19	X036B6006Z					2	2	2	2			Hinge - Engine Compartment	

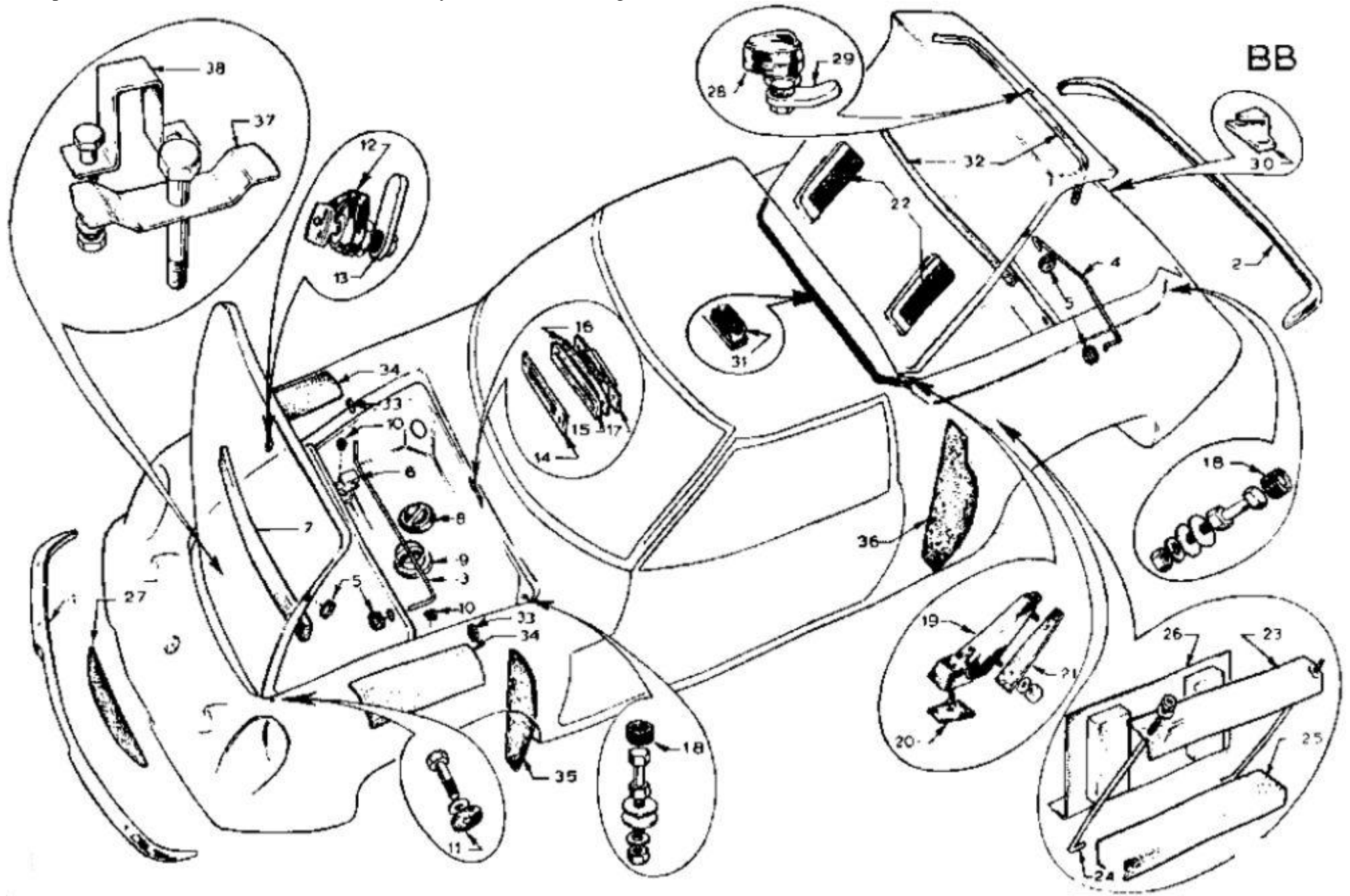

Lotus Europa TC/TCS Parts Manual - Section BB - Body - Attachments - Page 4

Item	Lotus #	S1	S1A/B	S2	S2 Fed	TC	TC Fed	TCS	TCS F	LHD	RHD	Description	Change Point Notes Bulletin Reference
20	A036B1111Z					2	2	2	2			Engine Compartment Lid Hinge Front Gasket	
21	A036B1112Z					2	2	2	2			Engine Compartment Lid Hinge Rear Gasket	
21	113					4	4	4	4			Washer - Hinge to Lid	
21	206					4	4	4	4			Nut - Hinge to Lid	
21	119					2	2	2	2			Washer - Hinge to Body	
21	210A					2	2	2	2			Nut - Hinge to Body	
22	A074U0011Z					2	2	2	2			Grille - Engine Compartment Lid	
22	316B					8	8	8	8			Screw - Grille Securing	
22	422					8	8	8	8			Nut - Grille Securing	
23	A074U0014Z					1	1	1	1			Clamp - Battery	
24	C074U0015Z					2	2	2	2			Rod - Battery Clamp	
25	A054B6111V											Strip - Rubber (As Required)	
26	A074B0026Z					1	1	1	1			Shield - Battery Heat	
27	X046B0272Z					1	1	1	1			Grille - Front	
27	RSTS0808					8	8	8	8			Screw - Grille Securing	
27	421					8	8	8	8			Nut - Grille Securing	
27	102					8	8	8	8			Washer - Grille Securing	
28	X046B6112Z					1	1	1	1			Lock - Engine Compartment Lid	
29	X046B1367Z					1	1	1	1			Tab - Lock	
30	X046B1366Z					1	1	1	1			Plate - Latch	
30	318B ?					2	2	2	2			Screw - Plate Securing	
30	102					2	2	2	2			Washer - Plate Securing	
30	423					2	2	2	2			Nut - Plate Securing	
31	A074V6006V					1	1	1	1			Seal - Engine Compartment	
32	X046B1289Z					2	2	2	2			Strip - Foam - Engine Compartment Lid	
33	X026B0731Z					2	2	2	2			Gromet - Upper Wishbone Access	
34	A036V0083V					2	2	2	2			Guard - Stone	
35	X054B1271Z					2	2	2	2			Plate - Closing - Front Wheel Arch	
35	X054B1272Z					2	2	2	2			Plate - Closing - Rear Wheel Arch	
35	434					24	24	24	24			Rivet - Plate Securing	
35	100					48	48	48	48			Washer - Plate Securing	
37	X036B0599Z					1	1	1	1			Clamp - Spare Wheel (Steel Wheel Only)	
38	A074U0028Z					1	1	1	1			Bracket - Wheel Support (Steel Wheel Only)	

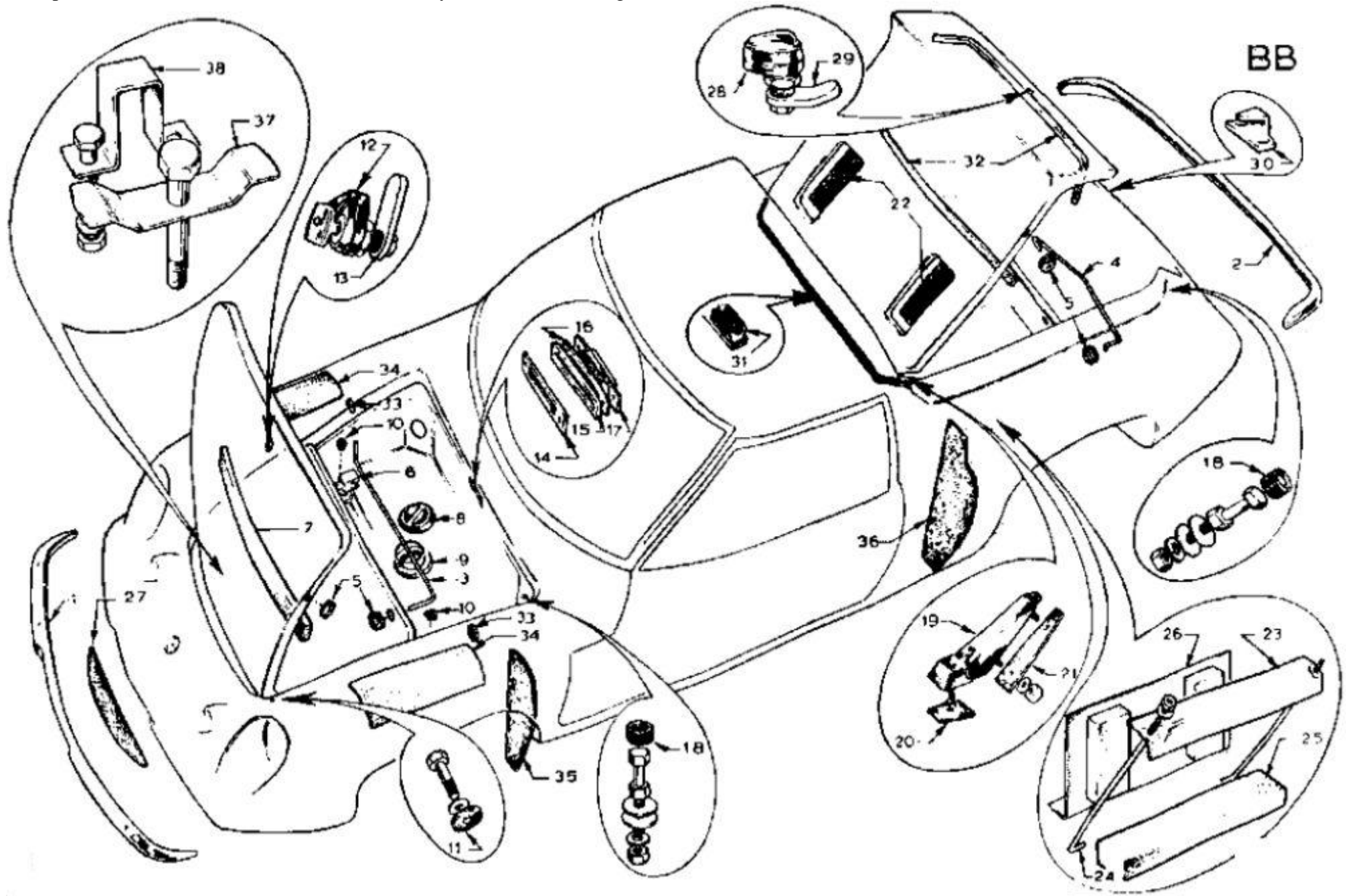

Lotus Europa TC/TCS Parts Manual - Section BB - Body - Attachments - Page 6

Item	Lotus #	S1	S1A/B	S2	S2 Fed	TC	TC Fed	TCS	TCS F	LHD	RHD	Description	Change Point Notes Bulletin Reference
38	4__					2	2	2	2			Bolt - Bracket Securing	
38	110					2	2	2	2			Washer - Bracket Securing	
38	208					2	2	2	2			Nut - Bracket Securing	
38	125					1	1	1	1			Washer - Spare Wheel Securing (Alloy Wheel Only)	
38	30A					1	1	1	1			Bolt - Spare Wheel Securing (All)	