

SA

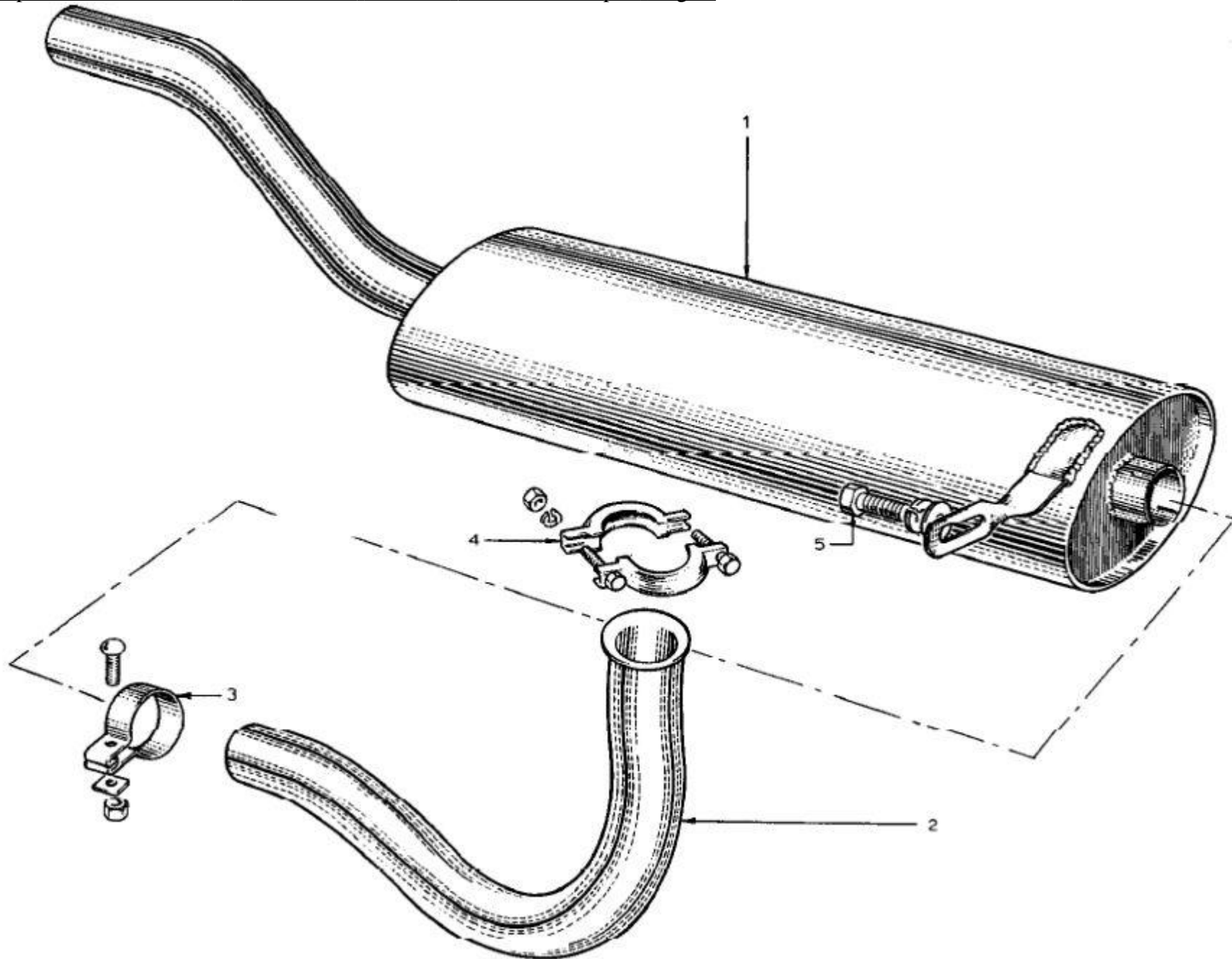

Lotus Europa S1/S2 Parts Manual - Section SA - Exhaust - Silencer and Pipes - Page 2

Item	Lotus #	S1	S1A/B	S2	S2 Fed	TC	TC Fed	TCS	TCS F	LHD	RHD	Description	Change Point Notes Bulletin Reference
1	046S0010											Replaced by A046S0010 with 1 of A046S0002	Up to Chassis No. 0148 SB - Service 1967/64
1	046S0093											Replaced by A046S0010 with 1 of A046S0002	SB - Service 1967/64
1	A046S0010	1	1	1	1							Silencer	From Chassis No. 0149 to ?
1	B046S0010	1	1	1	1							Silencer	From Chassis No. ?
1	046S0002											Replaced by A046S0002	Up to Chassis No. 0148
2	A046S0002	1	1	1	1							Down Pipe	From Chassis No. 0149
2	046S0104	2	2									Clip - Silencer Mounting	Up to Chassis No. 0148
3	046S6026			1	1							Clip - Silencer Mounting	From Chassis No. 0149
3	046E6400											Replaced by 046E6143	
4	046E6143	1	1	1	1							Half Clamp - Down Pipe to Manifold	
4	046E6401											Replaced by 046E6467	
4	046E6467	1	1	1	1							Half Clamp - Down Pipe to Manifold	
4	LUFN050F	2	2	2	2							Nut - Down Pipe Clamp	5/16" x 24 TPI, 1/2" head
4	A046W6018	2	2	2	2							Washer - Down Pipe Clamp	
4	XUFS0512	2	2									Bolt - Clamps to Pipes	3/4" long, all thread, 5/16" x 24 TPI, 1/2" head
4	A05W1007	2	2									Washer - Clamps to Pipes	1/16" thick, 5/8" OD and 9/32" ID
4	L0520000	2	2									Washer - Clamps to Pipes	
4	XUFN050F	2	2									Nut - Clamps to Pipes	
4	046E6460	2	2	2	2							Screw - Silencer Mounting	
4	L05W0000	2	2	2	2							Washer - Silencer Mounting	7/64" thick split washer, 19/32" OD, 5/16" ID
4	A05W1007	2	2	2	2							Washer - Silencer Mounting	1/16" thick, 5/8" OD and 9/32" ID
4	XUFS0512			1	1							Bolt - Clamp - Silencer to Down Pipe	3/4" long, all thread, 5/16" x 24 TPI, 1/2" head
4	LUFN050F			1	1							Nut - Clamp - Silencer to Down Pipe	5/16" x 24 TPI, 1/2" head