

FF

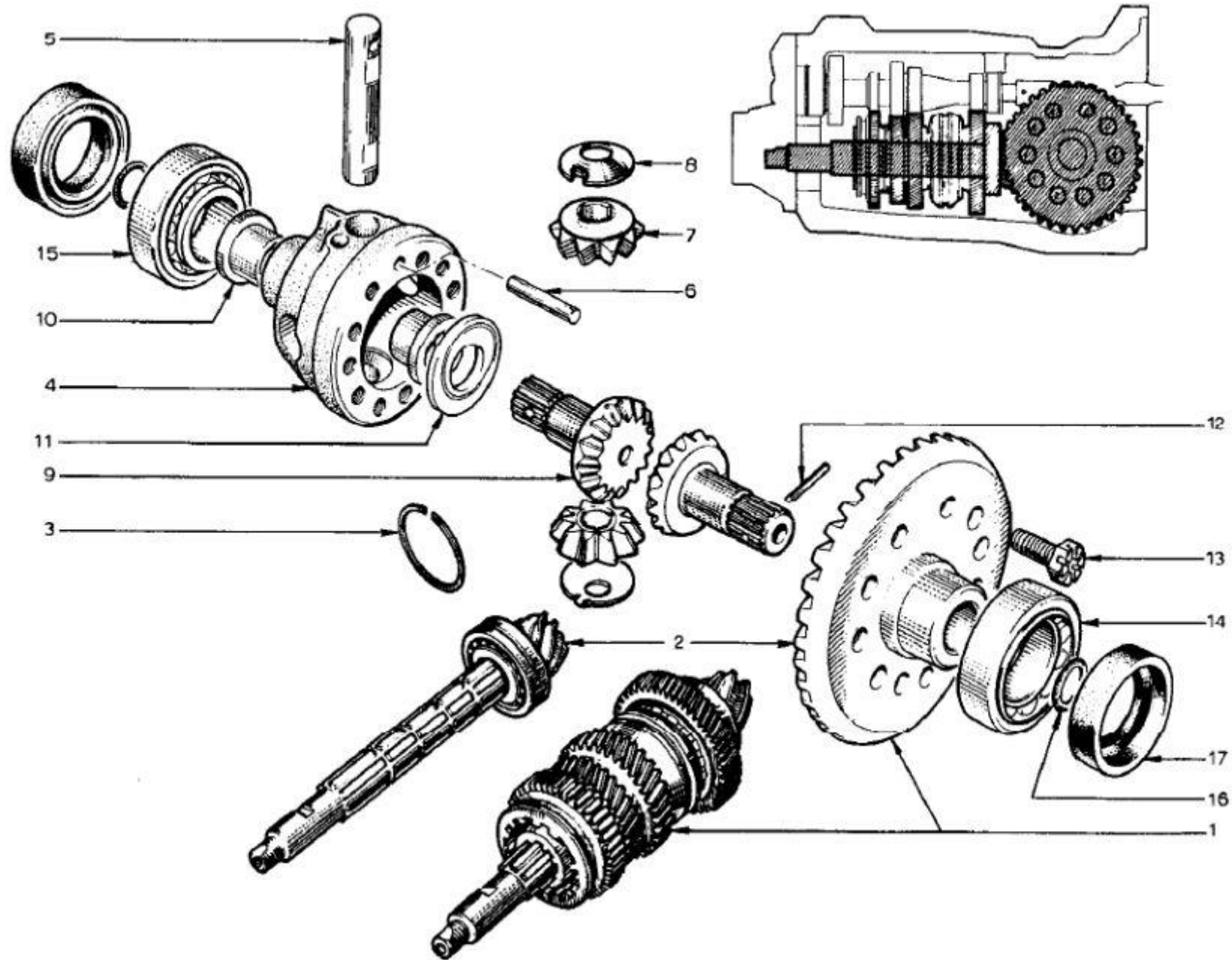

Lotus Europa S1/S2 Parts Manual - Section FF - Transmission - Crown Wheel and Pinion - Page 2

Item	Lotus #	S1	S1A/B	S2	S2 Fed	TC	TC Fed	TCS	TCS F	LHD	RHD	Description	Change Point Notes Bulletin Reference
1	046F6143	1	1	1	1							Crown Wheel & Pinion with Gear Set (Type 336-08)	
1	A046F6143	1	1	1	1							Crown Wheel & Pinion with Gear Set (Type 336-46)	
1	B046F6143	1	1	1	1							Crown Wheel & Pinion with Gear Set (Type 336-56)	
2	046F6131	1	1	1	1							Crown Wheel 7 Pinion - Yellow	
2	046F6132	1	1	1	1							Crown Wheel 7 Pinion - Blue	
3	046F6129	1	1	1	1							Circlip	
4	046F6127											Replaced by A046F6192 with 1 of A046F6193 Differential Pin & 1 of A046F6124 Tension Pin	Up to Engine No. ?
4	A046F6192	1	1	1	1							Carrier - Crown Wheel	From Engine No. ?
5	046F6125	1	1	1	1							Differential Pin (697-04)	Up to Engine No. ?
5	A046F6193	1	1	1	1							Differential Pin (697-04)	From Engine No. ?
5	B046F6193	1	1	1	1							Differential Pin	From Engine No. ?
5	C046F6193	1	1	1	1							Differential Pin	From Engine No. ?
6	046F6124	1	1	1	1							Tension Pin 4 x 40 mm.	Up to Engine No. ?
6	A046F6124	1	1	1	1							Tension Pin 5 x 40 mm.	From Engine No. ?
7	046F6136	2	2	2	2							Star Wheel	Up to Engine No. ?
7	A046F6136	2	2	2	2							Star Wheel	From Engine No. ?
8	046F6135	2	2	2	2							Shim - Star Wheel	
9	046F6138	2	2	2	2							Drive Shaft	
10	046F6137	2	2	2	2							Bushing - Drive Shaft	
11	046F6144											Shim - Optional As Required	
11	046F6145											Shim - Optional As Required	
12	046F6188	2	2	2	2							Tension Pin 7 x 40 mm.	
13	046F6194	10	10	10	10							Screw - Crown Wheel to Carrier	
14	046F6142	1	1	1	1							Bearing - Differential Carrier	
15	046F6126	1	1	1	1							Bearing - Differential Carrier	
16	046F6140	2	2	2	2							O Ring	
17	046F6141	2	2	2	2							Seal Ring or 046F6141A	
17	046F6141A	2	2	2	2							Seal Ring or 046F6141	