

FC

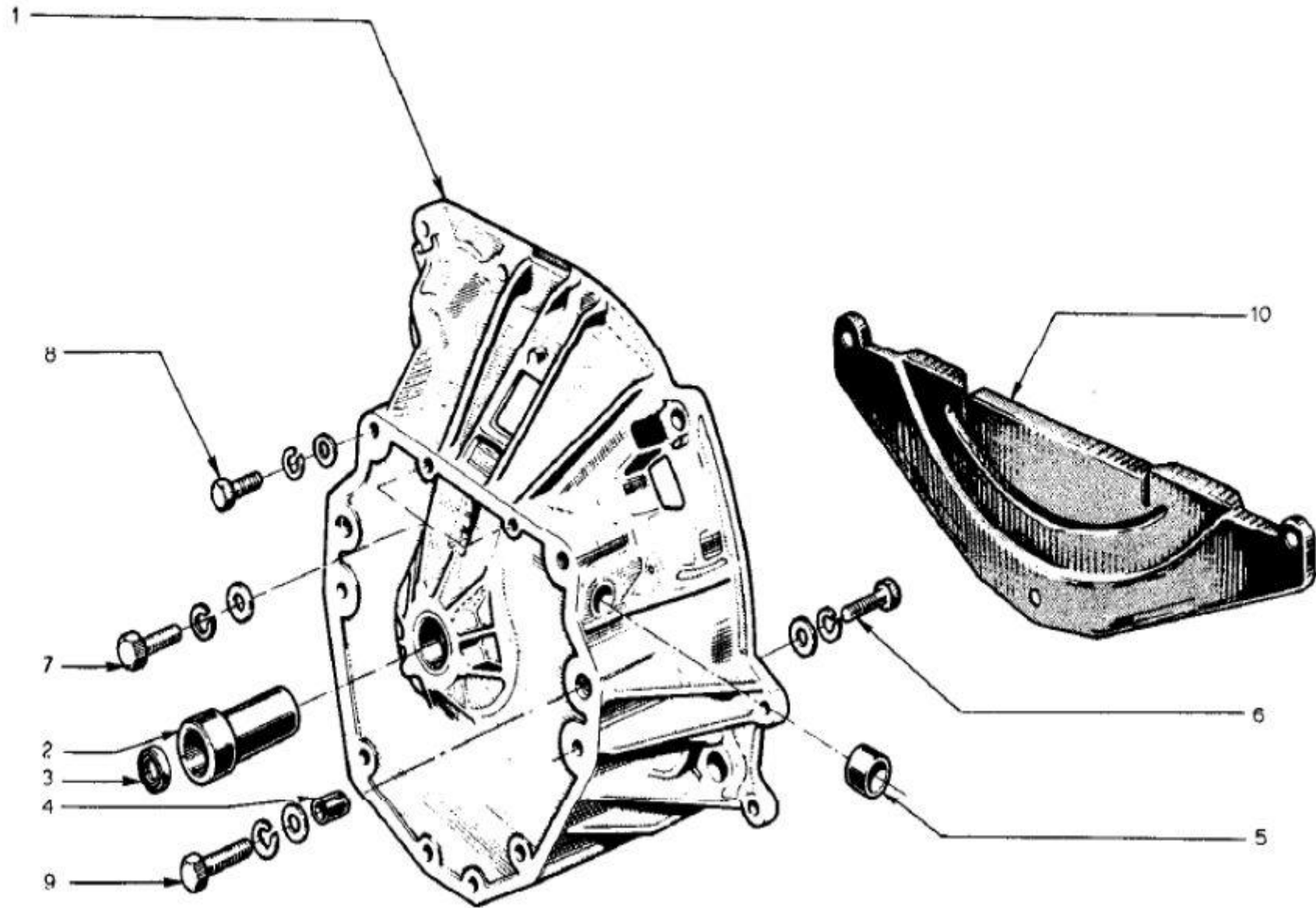

Lotus Europa S1/S2 Parts Manual - Section FC - Transmission - Bell Housing - Page 2

| Item | Lotus # | S1 | S1A/B | S2 | S2 Fed | TC | TC Fed | TCS | TCS F | LHD | RHD | Description | Change Point Notes Bulletin Reference |
|------|-----------|----|-------|----|--------|----|--------|-----|-------|-----|-----|---|--|
| 1 | 046F6020 | 1 | 1 | 1 | 1 | | | | | | | Bell Housing - Replaced by A046F6020 with 3 of A046W6116 Bolt | 697-04 Up to Eng. No. ? - Type 336-26 Up to gearbox No. 0420 |
| 1 | A046F6020 | 1 | 1 | 1 | 1 | | | | | | | Bell Housing | From Chassis No. ? - Type 336-26 From Gearbox No. 0421 - Type 336-46 From Gearbox No. 0001 |
| 2 | 046F6021 | 1 | 1 | 1 | 1 | | | | | | | Seal Carrier | |
| 3 | 046F6022 | 1 | 1 | 1 | | | | | | | | Seal (697-04) | |
| 3 | A046F6022 | | | | 1 | | | | | | | Seal (821-30) | |
| 4 | 046F6023 | 2 | 2 | 2 | 2 | | | | | | | Bushing | |
| 5 | 046F6024 | 2 | 2 | 2 | 2 | | | | | | | Bushing - Cross Shaft | |
| 6 | A046W6081 | 6 | 6 | 6 | 6 | | | | | | | Bolt 8 x 30 | |
| 7 | A046W6098 | 2 | 2 | 2 | 2 | | | | | | | Bolt 8 x 25 | |
| 7 | A046W6018 | 8 | 8 | 8 | 8 | | | | | | | Spring Washer | |
| 7 | A046W6002 | 8 | 8 | 8 | 8 | | | | | | | Washer | |
| 8 | A046W6097 | 2 | 2 | 2 | 2 | | | | | | | Bolt 10 x 35 | |
| 9 | A046W6009 | 2 | 2 | 2 | 2 | | | | | | | Bolt 10 x 45 | |
| 9 | A046W6009 | 4 | 4 | 4 | 4 | | | | | | | Spring Washer | |
| 9 | A046W6010 | 4 | 4 | 4 | 4 | | | | | | | Washer | |
| 9 | A046F6196 | | | 2 | | | | | | | | Plug (Type 336-26) | From Gearbox No. 0421 |
| 9 | A046f6196 | | | | 2 | | | | | | | Plug (Type 336-46) | From Gearbox No. 0066 |
| 10 | A046F6200 | 1 | 1 | 1 | 1 | | | | | | | Dirt Shield | |